

SPECIFICATIONS

And

RELATED DOCUMENTS

for construction of

Rolla Street Storm Sewer Improvements

in

ROLLA, MISSOURI

PROJECT NO. 598

APRIL 2026

Prepared by

**CITY OF ROLLA
DEPARTMENT OF
PUBLIC WORKS**

901 North Elm Street, Rolla, Missouri

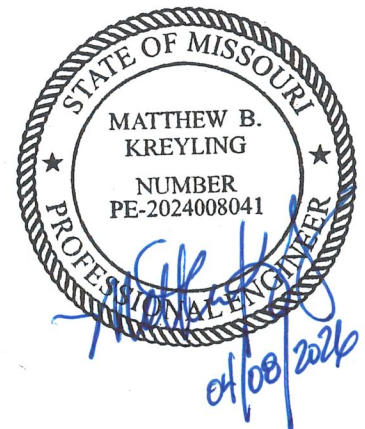

INVITATION TO BID

The City of Rolla hereby requests bids for the following project: **Rolla Street Storm Sewer Improvements, Project 598.**

Bids will be accepted until **11:00 a.m., Wednesday, April 29, 2026**, in the office of the City Clerk, 3rd Floor, 901 North Elm Street, Rolla, Missouri, at which time they will be opened. Bids shall be submitted in a sealed envelope and clearly marked **“Rolla Street Storm Sewer Improvements, Project 598”**.

Mandatory Pre-bid Conference will be held on **Wednesday, April 15th, 2026 at 11:00 a.m.** in the 4th floor conference room of the Public Works Department, 901 North Elm Street, Rolla, Missouri.

The Rolla Street Storm Sewer Improvements project consists of the replacement of the storm sewer system that collects storm runoff on Rolla Street between 5th Street & 12th Street and discharges east of the intersection of Rolla Street & 5th Street. The project includes installation of a new box culvert from the discharge point north to 10th Street, and the installation of additional inlets and piping to collect stormwater from nearby streets. Contractor shall be responsible for, but not limited to: excavation and removal of current improvements as needed, grading and backfill, milling and paving, additional utility coordination, water main relocation at 6th & Rolla Streets, additional sanitary sewer main and lateral connections, traffic control and detours.

Contractor shall be responsible for compliance with Section 290.250 of the Revised Missouri Statutes pertaining to prevailing wages.

Only Missouri laborers and laborers from nonrestrictive states are allowed by law to be employed on Missouri’s public works projects when the unemployment rate exceeds 5% for two consecutive months. (Sections 290.3081 through 290.580 R.S.Mo.)

Bidders are informed that pursuant to Section 285.530, R.S.Mo, as a condition of the award of any contract in excess of five thousand dollars (\$5,000.00), the successful bidder shall, by sworn affidavit and provision of documentation, affirm its enrollment and participation in a federal work authorization program with respect to the employees working in connection to the contracted services. Successful bidders shall also sign an affidavit affirming that it does not knowingly employ any person who is an unauthorized alien in connection to the contracted services.

Bidders are informed that the project is subject to the requirements of Section 292.675, R.S.Mo, which requires all contractors or subcontractors doing work on the project to provide, and require its on-site employees to complete, a ten (10) hour course in construction safety and health approved by the Occupation Safety and Health Administration (“OSHA”) or a similar program approved by the Missouri Department of Labor and Industrial Relations which is at least as stringent as an approved OSHA program. The training must be completed within sixty (60) days of the date work on the

project commences. On-site employees found on the worksite without documentation of the required training shall have twenty (20) days to produce such documentation.

All bidding Contractors shall be expected to review the scope of the work with a representative of the City Public Works Department prior to bidding.

All bids shall be on the proposal form provided and shall be accompanied by submittals and a bid bond issued by an acceptable surety company and payable to the order of the City of Rolla, for not less than five percent (5%) of the total amount of the bid.

The successful Contractor shall be expected to proceed as expeditiously as possible upon receipt of the **NOTICE TO PROCEED** and complete the project by **May 1, 2027**. The anticipated date for the Notice to Proceed is **June 8, 2026**.

The Contractor shall perform with its own organization contract work amounting to not less than thirty (30) percent of the total original contract price, excluding any specialty items designated by the City. Payment shall be based on actual measured quantities.

Liquidated Damages - Should the contractor fail to complete the work on or before the completion date specified the contractor will be charged liquidated damages in the amount of **\$500.00** per calendar day for each full calendar day that the work is not fully completed. Liquidated damages will not be charged for weekends and holidays.

The project will be awarded to the lowest, responsive, responsible bidder.

The City reserves the right to reject any and all bids. All work shall be done in adherence to the City of Rolla Standards and Specifications.

There are utilities that need to be moved in relation to this project, as indicated in the construction documents. Additionally, the contractor will need to coordinate with other utilities during construction. It is the contractor's responsibility to verify the location of all existing utilities. Please refer to the index sheet of project plans for phone numbers associated with appropriate utility companies.

Bid documents and specifications may be reviewed in, or purchased for \$35.00 from the Rolla Public Works Department, 4th Floor, 901 North Elm Street, Rolla, Missouri 65401. Bid documents can be picked up Monday through Friday, 8:00 a.m. to 5:00 p.m. PDF copies will be emailed at no cost. Specifications and the plan sheet can also be downloaded at www.rollacity.gov/bids.

Matthew Kreyling, P.E.
City Engineer

TABLE OF CONTENTS

Notice to Bidders 3

Instructions to Bidders 9

Information for Bidders 11

I. Contract Documents 11

II. Bidder’s Obligation..... 11

III. Document Interpretation..... 11

IV. Proposals..... 12

V. Modification and Withdrawal of Bids 12

VI. Signing of Proposals..... 13

VII. Award of Contract 13

VIII. Contract Security 14

IX. Notice to Proceed..... 14

X. Number of Construction Documents 14

Proposal 15

Contract Agreement 18

Transient Employer - Lawful Presence 21

Affidavit of Work Authorization & Documentation 23

Bid Price..... 27

Quotation Form..... 29

General Conditions 31

Contract Documents 31

1.1 Definition 31

1.1.1 The Contract Documents 31

1.1.2 The Contract..... 31

1.1.3 The Work..... 31

1.1.4 The Project 31

1.2 Execution, Correlation and Intent 31

1.3 Ownership and Use of Documents..... 32

Public Works Director..... 33

2.1 Definition 33

2.2 Administration of the Contract 33

City..... 37

3.1 Definition 37

3.2 Information and Services Required of the Owner..... 37

3.3 City’s Right to Stop the Work 37

3.4	City's Right to Carry out the Work	38
Contractor	39
4.1	Definition	39
4.2	Review of Contract Documents	39
4.3	Supervision and Construction Procedures	39
4.4	Before Final Payment - Required Final Forms Completion.....	39
4.5	Labor and Materials.....	40
4.6	Warranty	40
4.7	Taxes.....	40
4.8	Permits, Fees and Notices.....	40
4.9	Allowances	41
4.10	Superintendent	41
4.11	Progress Schedule	41
4.12	Documents and Samples at the Site.....	41
4.13	Shop Drawings, Product Data and Samples.....	42
4.14	Use of Site.....	42
4.15	Cutting and Patching of Work	43
4.16	Cleaning Up	43
4.17	Communications	43
4.18	Royalties and Patents.....	43
4.19	Indemnification	43
Subcontractors	45
5.1	Definition	45
5.2	Award of Subcontractors and Other Contracts for Portions of the Work.....	45
5.3	Subcontractual Relations	46
Work by City or by Separate Contractors	47
6.1	City's Right to Perform Work and to Award Separate Contracts	47
6.2	Mutual Responsibility.....	47
6.3	City's Right to Clean Up	48
Miscellaneous Provisions	49
7.1	Governing Law.....	49
7.2	Successors and Assigns	49
7.3	Written Notice	49
7.4	Claims for Damage	49
7.5	Performance Bond and Labor and Material Payment Bond.....	49
7.6	Rights and Remedies.....	49
7.7	Tests.....	50
7.8	Interest	50
7.9	Arbitration.....	50
8.0	Buy America Policy.....	51
Time	53
8.1	Definitions.....	53
8.2	Progress and Completion	53
8.3	Delays and Extensions of Time	53

Payments and Completion	55
9.1 Contract Sum	55
9.2 Schedule of Values	55
9.3 Applications for Payment.....	55
9.4 Certificates for Payment.....	56
9.5 Progress Payments	56
9.6 Payments Withheld.....	57
9.7 Failure of Payment.....	57
9.8 Substantial Completion	58
9.9 Final Completion and Final Payment	58
Protection of Persons and Property	61
10.1 Safety Precautions and Programs	61
10.2 Safety of Persons and Property	61
10.3 Emergencies.....	62
10.4 Occupational Safety & Health Administration (OSHA).....	62
10.5 Overhead Line Safety Act - MO Revised Statute	63
Insurance.....	67
11.1 Contractor's Liability Insurance.....	67
11.2 City's Liability Insurance	67
11.3 Contractor's Builders' Risk Insurance.....	68
Changes in the Work.....	69
12.1 Change Orders	69
12.2 Concealed Conditions	70
12.3 Claims for Additional Cost	70
12.4 Minor Changes in the Work	70
Uncovering and Correction of Work.....	71
13.1 Uncovering of Work	71
13.2 Correction of Work.....	71
13.3 Acceptance of Defective or Non-Conforming Work.....	72
Termination of the Contract.....	73
14.1 Termination of the Contract	73
14.2 Termination by the City	73
Supplemental General Conditions	75
15.1 Certificate of Owner's Attorney	75
15.2 Conflict of Interest	75
15.3 Copeland "Anti-Kick-Back Act"	75
15.4 Clean Air Act.....	76
Special Conditions.....	77
1.1 Insurance	77
1.2 Workers' Compensation Insurance.....	77
1.3 Public Liability and Property Damage Insurance.....	77
2.1 Time for Completion.....	78
3.1 Liquidated Damages	78
4.1 Special Wage Determination	79
5.1 Nondiscrimination in Employment.....	79
6.1 Payments	79

8.1	Location and Grade.....	80
9.1	Hold Harmless Agreement.....	80
10.1	Affidavit Compliance of the Prevailing Wage Law	80
11.1	Contractor's Affidavit Regarding Settlement of Claims.....	81
	Hold Harmless Agreement Form.	83
	Affidavit Compliance of the Prevailing Wage Law	85
	Contractor's Affidavit Regarding Settlement of Claims.....	87
	Wage Rates	97
	Job Special Provisions	99

INSTRUCTIONS TO BIDDERS

1. Bids must be submitted on the “Bidder’s Proposal” form only. Bids must be submitted in a sealed envelope, properly identified with the project name and number. Attached to the Bid Proposal shall be any applicable information or specification sheets, properly filled out, for the items bid.
2. The Bid must be filed with the City Clerk prior to the announced bid opening date and time.
3. The City of Rolla reserves the right to accept or reject any and/or all bids.
4. It will be the City’s intent to accept low competent bid if it meets specifications and conditions.
5. The successful Contractor shall be expected to proceed as expeditiously as possible upon receipt of the **NOTICE TO PROCEED** and complete the project by **May 1, 2027**. The anticipated date for the Notice to Proceed is **June 8, 2026**.
6. Liquidated Damages - Should the contractor fail to complete the work on or before the completion date specified the contractor will be charged liquidated damages in the amount of **\$500.00** per calendar day for each full calendar day that the work is not fully completed. Liquidated damages will not be charged for weekends and holidays.
7. Bidders are advised that the City of Rolla shall consider prior substandard goods or prior substandard service delivery or excessive distance to the City as a criterion for bid rejection.
8. Bids equal in cost and specifications may go to the local bidder (given they meet all other conditions).
9. All bids shall meet or exceed specifications.
10. Alternate bids may be considered, providing all specification differences are clearly indicated and contain justification statements. The City of Rolla shall be the sole judge as to the suitability of the service or equipment offered for the intended purpose from the alternate bid.
11. Any exceptions to these terms or conditions or deviations from written specifications shall be shown in writing and attached to the Bidder’s Proposal.

12. Bidders are cautioned to verify their proposal before submission as requests for amendments, withdrawals or proposals, if received by the City after the time specified for opening, will not be considered.
13. In the event of discrepancies between Bidder's "Per Unit" price quotation and "Extended Total" quotation, the "Per Unit" quotation shall prevail.
14. Bidders must be factory authorized dealers for the equipment, service and parts of the items they are bidding.
15. Local bidders shall be defined as bidders in Rolla and the area surrounding Rolla for a five-mile radius from the city limits.
16. Successful bidder will be required to have the appropriate City of Rolla business license.
17. All questions regarding plans or specifications must be directed to the Department of Public Works no later than 4 working days prior to time for receipt for proposals. Addendums will be provided to all bidders.
18. Traffic Control will be provided by the contractor.
19. Resident notification will be provided by the City of Rolla. Contractor to coordinate schedule with Public Works staff.
20. The Contractor shall perform with its own organization contract work amounting to not less than thirty (30) percent of the total original contract price, excluding any specialty items designated by the City. Payment shall be based on actual measured quantities.

INFORMATION FOR BIDDERS

I. CONTRACT DOCUMENTS

- A. Plans, Specifications, and other contract documents, pursuant to which work is to be done, may be obtained at the office of the Public Works Director.
- B. The number of sets obtainable by any one party may be limited in accordance with available supply.
- C. Copies of drawings and specifications are on file at the office specified in Subparagraph A above for the convenience of subcontractors and suppliers and may be seen and examined during regular business hours.

II. BIDDER'S OBLIGATION

- A. Before submitting proposals each bidder shall carefully examine drawings, specifications, and related contract documents, visit site of work and fully inform himself as to all existing conditions, facilities, restrictions, and other matters which can affect the work or the cost thereof.
- B. It is required that each bidder attend the pre-bid conference as outlined in the notice to bidders.
- C. Each bidder shall include in his proposal the cost of all work and materials required to complete the contract in as hereinafter specified.
- D. Failure or omission of any bidder to receive or examine any form, instrument, addendum, or other document, or to visit site and acquaint himself with existing conditions, shall in no way relieve him from any obligation with respect to his proposal or contract, and no extra compensation will be allowed by reason of anything or matter concerning which bidder should have fully informed himself prior to bidding.
- E. Submission of proposals shall be deemed acceptance of the above obligations and each and every obligation required to be performed by all of the contract documents in the event the proposal is accepted.

III. DOCUMENT INTERPRETATION

- A. If any prospective bidder is in doubt as to the true meaning of any part of the specifications, drawings, or contract documents, he must submit a written request to the Public Works Director for an interpretation.
- B. Requests for such interpretations must be delivered to the Public Works Director at least 48 hours prior to time for receipt of proposals.

- C. Proposals are to be based only on interpretations as issued in form of addenda mailed only to each person who is on the Public Works Director's record as receiving a set of the Contract Documents.

IV. PROPOSALS

Proposals will be received for the construction of **“Rolla Street Storm Sewer Improvements, Project 598.”**

- A. Bidders shall apportion each Base Bid between various phases of the work, as stipulated in the Proposal Form. All work is to be done as defined in specifications and as indicated on drawings.
- B. Proposals are to be presented in sealed envelopes which are to be plainly marked: **“Rolla Street Storm Sewer Improvements, Project 598”** and mailed or delivered to the place specified in the Advertisement for Bids. Bidders shall be responsible for actual delivery of proposals during business hours, and it shall not be sufficient to show that a proposal was mailed in time to be received before scheduled closing time for receipt of proposal.
- C. Bidder's proposal shall include all city, state and federal sales, excise and similar taxes which may be lawfully assessed and all permits, governmental fees and licenses in connection with his performance of work and purchase of materials to be incorporated in the work.
- D. No bidder shall stipulate in his proposal any conditions not contained in the proposal form.
- E. The Owner reserves the right to waive informalities in proposals and to reject any or all proposals.

V. MODIFICATION AND WITHDRAWAL OF BIDS

- A. Bidder may withdraw his proposal at any time prior to scheduled closing time for receipt of proposals, but no bidder may withdraw his proposal for the period of time specified in the Form of Proposal after scheduled closing time for receipt of bids.
- B. In the event any proposal is withdrawn after the scheduled closing time for receipt of proposals or bidder fails or refuses to execute contracts in accordance with a proposal acceptable to the City, or any other proposals submitted by such bidder may be considered by the City to have been withdrawn by such action on the part of the bidder.
- C. Only telegrams, letters, and other written requests for modifications or corrections of previously submitted proposals, which are addressed in the same manner as

proposals and are received by the City Clerk prior to scheduled closing time for receipt of proposals, will be accepted and proposal corrected in accordance with such written requests with the following provisions:

1. Provided that any such written request is contained in a sealed envelope which is plainly marked: “**Rolla Street Storm Sewer Improvements, Project 598.**”
2. That in case of telegraphic modification the City is satisfied that written confirmation of such telegraphic modification over the signature of bidder was mailed prior to closing time. If such written confirmation is not received within two days from date of closing time, no consideration shall be given to telegraphic modifications.

VI. **SIGNING OF PROPOSALS**

- A. Proposals which are signed for a partnership shall be signed in the firm name by all partners, or in the firm name by Attorney-in-fact. If signed by Attorney-in-fact, there should be attached to the proposal a Power of Attorney-in-fact evidencing authority to sign the proposal, dated the same date as the proposal and executed by all partners of the firm.
- B. Proposals which are signed for a corporation shall have the correct corporate name thereon and the signature of the president, attested by the Secretary and bear the corporate seal of the corporation.
- C. Proposals which are signed by an individual doing business under a firm name shall be signed in the name of the individual doing business under the proper firm name and style.

VII. **AWARD OF CONTRACT**

- A. Subject to rights reserved, all work to be performed under these specifications will be awarded to one Contractor unless specifically modified under special conditions.
- B. The City reserves the right to let other contracts in connection with the work, including but not by way of limitation, contracts for furnishing and installation of furniture, equipment, machines, appliances and other apparatus.
- C. In awarding the contract the city may take into consideration the ability to promptly handle the additional work, skill, facilities, capacity, experience, ability, responsibility, previous work and financial standing of bidder, quality, efficiency and construction of equipment proposed to be furnished, period of time within which equipment is proposed to be furnished and delivered, and necessity of prompt and efficient completion of work herein described. Inability of any bidder

to meet the requirements mentioned above may be cause for rejection of his proposal.

VIII. **CONTRACT SECURITY**

- A. Each Bid must be accompanied by a bid bond payable to the owner for five percent (5%) of the total amount of the bid. As soon as the bid prices have been compared, the owner will return the bonds of all except the three lowest responsible bidders. When the agreement is executed the bonds of the two remaining unsuccessful bidders will be returned. The bid bond of the successful bidder will be retained until the payment bond and performance bond have been executed and approved, after which it will be returned. Only a bid bond issued by an acceptable surety company will be accepted with each bid.
- B. Contractor shall furnish a performance bond in an amount at least equal to 100 percent (100%) of the contract price as security for the faithful performance of his contract and for the payment of all persons performing labor on the project and furnishing materials in connection therewith under his contract as set forth in the standard form of performance bond. The surety on such bond shall be a duly authorized surety company satisfactory to the City.
- C. Contractor shall furnish at no cost to the City, no later than the time at which the executed contract and bond are returned, a properly certified copy of the current Certificate of Authority to transact business in the State of Missouri of the surety company executing the required performance bond, such certificate to remain on file with the City Clerk. No performance bond will be approved by the City until such a certificate is furnished unless there is on file with the City Clerk such a current certificate, in which event no additional certificate will be required during the period of time for which the current certificate is in effect.
- D. If at any time the City, for justifiable cause, shall be or become dissatisfied with any surety or sureties then upon the performance bond, the Contractor shall within five days after notice from the City to do so, substitute an acceptable bond signed by such other surety or sureties as may be satisfactory to the City.

IX. **NOTICE TO PROCEED**

- A. The successful Contractor shall be expected to proceed as expeditiously as possible upon receipt of the **NOTICE TO PROCEED** and complete the project by **May 1, 2027**. The anticipated date for the Notice to Proceed is **June 8, 2026**.

X. **NUMBER OF CONSTRUCTION DOCUMENTS**

- A. The City will furnish the Contractor a copy of the executed contract.

- B. The City will furnish the Contractor, free of charge, the number of complete sets of plans and specifications for the work and all applicable subdivisions thereof.
- C. The City will furnish the Contractor the number of copies of explanatory drawing changes required during construction as set forth in the Special Conditions.

PROPOSAL
FOR CONSTRUCTION OF
**Rolla Street Storm Sewer Improvements
Project 598**

FOR
ROLLA, MISSOURI

Proposal Submitted by: _____

To the City Council, City of Rolla, Missouri:

- I. This proposal is submitted for the Project entitled “**Rolla Street Storm Sewer Improvements, Project 598.**”
- II. The Contract Documents for these improvements are those prepared by the Public Works Department, City of Rolla, Missouri.
- III. In submitting this proposal, the undersigned declares that the only persons or parties interested in the proposal as principals are those named herein; and that the proposal is made without collusion with any other person, firm, or corporation.
- IV. A bid bond issued by an acceptable surety company and payable to the order of the City of Rolla, for not less than five percent (5%) of the total amount of the bid, is attached to this bid proposal.
- V. The undersigned further declares that he has carefully examined the proposal, plans and Specifications, and that he has familiarized himself with all of the local conditions affecting the contract and the detailed requirements of construction, and understands that in making this Proposal he waives all right to plead any misunderstanding regarding the same.
- VI. The undersigned has by investigation of the site of the work and otherwise satisfied himself as to the nature and location of the work and has fully informed himself as to all conditions and matters that can in any way affect the work or the cost thereof.
- VII. The undersigned further understands and agrees that if this Proposal is accepted he is to furnish and provide all necessary machinery, tools, apparatus and other means of construction, and to do all of the work and to furnish all of the materials

specified in the contract, except such materials and/or work to be furnished by the City, in the manner and at the time therein prescribed, and in accordance with the requirements therein set forth.

- VIII. The undersigned will execute the agreement and furnish the required performance and Payment Bonds and proof of insurance coverage within fourteen (14) days after notice to him of acceptance of his bid by the City; and further, that this bid may not be withdrawn for a period of sixty (60) days after the date set for the opening thereof. If any bidder shall withdraw his bid within said period, the Contractor shall be liable under the provisions of the Bid Security, or the Contractor and his surety shall be liable under the Bid Bond as the case may be.

CONTRACT AGREEMENT

THIS AGREEMENT, made and entered into this _____ Day of _____ by and between the City of Rolla, Missouri, Party of the First Part and hereinafter called Owner, and _____ Party of the second Part and hereinafter called the Contractor.

WITNESSETH:

THAT WHEREAS, the Owner has caused to be prepared, in accordance with law, specifications, plans, and other Contract Documents for the work herein described, and has approved and adopted said documents, and has caused to be published and advertised for and in connection with the construction of: **Rolla Street Storm Sewer Improvements, Project 598**, in complete accord with the Contract Documents and the said plans and specifications; and

WHEREAS, the said Contractor, in response to such advertisement, has submitted to the Owner, in the manner and at the time specified, a sealed proposal in accordance with the terms of said advertisement; and

WHEREAS, the Owner, in the manner prescribed by law, has publicly opened, examined and canvassed the proposals submitted in response to the published invitation therefore, and as a result of such canvass has determined and declared the aforesaid Contractor to be lowest and best bidder for the said work and has duly awarded to the said Contractor a contract therefore, for the sum or sums named in the Contractor's proposal, a copy thereof being attached to and made a part of this contract.

NOW THEREFORE, in consideration of the compensation to be paid to the Contractor and of the mutual agreement herein contained, the parties to these presents have agreed and hereby agree, the Owner for itself and its successors, and the Contractor for itself, himself, or themselves, or its, his or their successors and assigns, or its, his, or their executors and administrators, as follows:

ARTICLE I. That the Contractor shall (a) furnish all tools, equipment, supplies, superintendent, transportation, and other construction accessories, services and facilities; (b) furnish all materials, supplies, and equipment specified and required to be incorporated in, and form a permanent part of the completed work except the items specified to be furnished by the Owner; (c) provide and perform all necessary labor, and (d) in a good, substantial, and workmanlike manner, and in accordance with the provisions of the General Conditions and the Special Conditions of the Contract, which are attached hereto and made a part hereof, and in conformity with the Contract Plans and Specifications designated and identified therein, execute, construct, and complete all work included in, and covered by the Owner's official award of this Contract to the said

Contractor, such award being based on the acceptance by the Owner of the Contractor's proposal, for the construction of **Rolla Street Storm Sewer Improvements, Project 598**.

It is further stipulated that not less than the prevailing hourly rate of wages as found by the Department of Labor and Industrial Relations of the State of Missouri, or determined by the Court of Appeal shall be paid to all workers performing work under this Contract.

ARTICLE II. Contractor acknowledges that Section 285.530, R.S.Mo, prohibits any business entity or employer from knowingly employing, hiring for employment, or continuing to employ an unauthorized alien to perform work within the State of Missouri. Contractor therefore covenants that it is not knowingly in violation of Subsection 1 of Section 285.530, R.S.Mo, and that it will not knowingly employ, hire for employment, or continue to employ any unauthorized aliens to perform work on the Project, and that its employees are lawfully eligible to work in the United States.

ARTICLE III. Occupational Safety and Health Administration (OSHA)

Safety Training:

- a. Contractor shall provide a ten (10) hour Occupational Safety and Health Administration (OSHA) construction safety program for all employees who will be on-site at the project. The construction safety program shall include a course in construction safety and health that is approved by OSHA or a similar program approved by the Missouri Department of Labor and Industrial Relations which is at least as stringent as an approved OSHA program as required by Section 292.675, R.S.Mo.
- b. Contractor shall require its on-site employees to complete a construction safety program within sixty (60) days after the date work on the project commences.
- c. Contractor acknowledges and agrees that any of Contractor's employees found on the project site without the documentation of the successful completion of a construction safety program shall be required to produce such documentation within twenty (20) days, or will be subject to removal from the project.
- d. Contractor shall require all of its subcontractors to comply with the requirements of this Section and Section 292.675, R.S.Mo.

Notice of Penalties for Failure to Provide Safety Training

- a. Pursuant to Section 292.675, R.S.Mo, Contractor shall forfeit to City as a penalty two thousand five hundred dollars (\$2,500.00), plus one hundred dollars (\$100.00) for each on-site employee employed by Contractor or its

Subcontractor, for each calendar day, or portion thereof, such on-site employee is employed without the construction safety training required in Safety Training section of Article III above.

- b. The penalty described in above subsection A of this section shall not begin to accrue until the time periods described in Sections B and C Safety Training of Article III above have elapsed.
- c. Violations of Article III – Safety Training above and imposition of the penalty described in this Section shall be investigated and determined by the Missouri Department of Labor and Industrial Relations.

ARTICLE IV. That the Contractor shall construct and complete the work designated and described in the foregoing proposal and attached specifications in accordance with the Notice to Bidders, Instruction to Bidders, Proposal, Bond, General Conditions, Special Conditions, Technical Specifications, Drawings, Addenda, and other component parts of the Contract Documents hereto attached, all of which documents from the Contract and are as fully a part hereto as if repeated verbatim herein.

ARTICLE V. That the Owner shall pay to the Contractor for the performance of the work described as follows: Complete construction of the improvements in accordance with plans and specifications; and the Contractor will accept as full compensation therefore, the sum (subject to adjustment as provided by the Contract) of _____ for All work covered by and included in the contract award and designated in the foregoing Article I. Payment therefore shall be made in the manner provided in the General Conditions attached hereto.

ARTICLE VI. That the Contractor shall begin assembly of materials and equipment within ten (10) days after receipt from the Owner of executed copies of the Contract.

Liquidated Damages - Should the contractor fail to complete the work on or before the completion date specified the contractor will be charged liquidated damages in the amount of **\$500.00** per calendar day for each full calendar day that the work is not fully completed. Liquidated damages will not be charged for weekends and holidays.

ARTICLE VII. Before the final payment can be made to the Contractor on the project, the Contractor must complete and return the Affidavit Compliance with the Prevailing Wage Law form furnished at the end of the Special Conditions section.

ARTICLE VIII. Before the final payment can be made on the project to the Contractor, the Contractor must complete and return the Contractor's Affidavit Regarding Settlement of Claims form furnished at the end of the Special Conditions section.

ARTICLE IX. This Contract will not be binding and effective until confirmed by the Owner.

IN WITNESS-WHEREOF: The parties have executed this Contract as of the day and year first above written.

CITY OF ROLLA, MISSOURI

CONTRACTOR

BY _____
Mayor, Owner, Party of the First Part

BY _____

Printed Name

Printed Name/Title

STATE OF MISSOURI)
SS)
County of Phelps)

On this _____ day of _____ before me appeared _____ ,
to me personally known, who, being by me duly sworn, did say that he is the Mayor of
the City of Rolla, Missouri, a municipal corporation, and the seal affixed to said
instrument is the corporate seal of said municipal corporation and that said instrument is
the corporate seal of said municipal corporation and that said instrument was signed
under authority of the City Council of
of the City of Rolla, Missouri; and the said _____ Acknowledged
said instrument to be the free act and deed of said municipal corporation.

My commission expires: _____

Notary Public

STATE OF MISSOURI)
SS)
County of Phelps)

On this _____ day of _____ before me appeared _____ ,
to me personally known, who, being by me duly sworn, did say that (s)he is the _____
of _____
and that the seal affixed to said instrument is the corporate seal of said corporation by
authority
of its board of directors; and the said _____ acknowledged said
instrument to be the free act and deed of said corporation.

My commission expires: _____

Notary Public

EVERY TRANSIENT EMPLOYER, as defined in Section 285.230, RSMo, enclosed in the laws section, must post in a prominent and easily accessible place at the work site a clearly legible copy of the following: (1) The notice of registration for employer withholding issued to such transient employer by the director of revenue; (2) Proof of coverage for workers' compensation insurance or self-insurance signed by the transient employer and verified by the department of revenue through the records of the division of workers' compensation; and (3) The notice of registration for unemployment insurance issued to such transient employer by the division of employment security. Any transient employer failing to comply with these requirements shall, under Section 285.234, RSMo, enclosed in the laws section, be liable for a penalty of five hundred dollars per day until the notices required by this section are posted a required by that statute.

PROOF OF LAWFUL PRESENCE - § 208.009

1. This Missouri Statute prohibits any illegal alien from receiving state or local "public benefits," and
2. The Statute requires all applicants at the time of application for such public benefits to provide "**affirmative proof** that the applicant is a citizen or a permanent resident of the United State or is lawfully present in the United States."

Affidavit of Work Authorization and Documentation

Effective January 1, 2009 and pursuant to 285.530 R.S.Mo, for all agreements in excess of \$5,000.00, the bidder must affirm its enrollment and participation in a federal work authorization program with respect to the employees proposed to work in connection with the services requested herein by

- submitting a completed, notarized copy of **“AFFIDAVIT OF COMPLIANCE WITH SECTION 285.500 R.S.MO., ET SEQ. FOR ALL AGREEMENTS IN EXCESS OF \$5,000.00”** and
- providing documentation affirming the bidder’s enrollment and participation in a federal work authorization program (see below) with respect to the employees proposed to work in connection with the services requested herein.

The City of Rolla encourages companies that are not already enrolled and participating in a federal work authorization program to do so.

E-Verify is an example of a federal work authorization program. Acceptable enrollment and participation documentation consists of the following two pages of the E-Verify Memorandum of Understanding (MOU): 1) a valid, completed copy of the first page identifying the bidder and 2) a valid copy of the signature page completed and signed by the bidder, the Social Security Administration, and the Department of Homeland Security - Verification Division.

Information regarding E-verify is available at http://www.dhs.gov/xprevprot/programs/gc_1185221678150.shtm, or by calling 888-464-4218.

AFFIDAVIT OF COMPLIANCE
SECTION 285.530.2

State of Missouri) ss

County of _____)

Now this ____ day of _____, 20 __, the undersigned, being first duly sworn, deposes and says:

1. I am more than 18 years of age.
2. I make this affidavit from my personal knowledge of the facts stated herein or upon information and facts available to me as a duly authorized owner, partner, corporate or LLC officer or Human Relations Director of _____

(name of Corporation, LLC, sole proprietorship or partnership)

3. I am authorized to make this affidavit on behalf of _____

(name of business entity, same as above)

4. I state and affirm that _____ is enrolled and is currently

Name of business entity, same as above

participating in E-Verify, a federal work authorization program or another equivalent electronic verification of work authorization program operated by the United States Department of Homeland Security under the Immigration Reform and Control Act of 1986.

5. Further, _____ does not knowingly employ any person who is

(name of business entity, same as above)

an unauthorized alien.

6. Further, _____ has performed an electronic verification check

(name of business entity, same as above)

as described above on all workers hired since January 1, 2009 or obtained documents required for completion of a federal I-9 form before it began participating in e-verify.

7. Attached to this affidavit is a true and accurate copy of this company's Memorandum of Understanding with the United States concerning the use of e-verify.

I certify under penalty of perjury that the statements above are complete, true and accurate to the best of my knowledge and belief.

(Authorized Agent, Partner, Owner or Officer)

If business has a Human Relations Director or equivalent that person must sign as an affiant as well.

I certify under penalty of perjury that the statements above are complete, true and accurate to the best of my knowledge and belief.

Human Relations Director

This form is promulgated pursuant to 15CSR 60-15.020. Use of this form is not required but the Attorney General has deemed this affidavit sufficient in form to satisfy the requirements of section 285.540, RSMo., Supp. 2008.

FURTHER THE AFFIANT SAYETH NOT

(Signature)

On this _____ day of _____ in the year 20 ____, before me, _____
_____, a Notary Public in and for said State,
personally appeared _____, known
to me to be the person who executed the within affidavit, and acknowledged to me that
he/she executed the same for the purposes therein stated.

IN WITNESS WHEREOF, I have hereunto set my hand and affixed my official
seal in the county and State aforesaid, the day and year first above written.

Notary Public

My Commission Expires:

BID PRICE

**Rolla Street Storm Sewer Improvements
Project 598**

The Rolla Street Storm Sewer Improvements project consists of the replacement of the storm sewer system that collects storm runoff on Rolla Street between 5th Street & 12th Street and discharges east of the intersection of Rolla Street & 5th Street. The project includes installation of a new box culvert from the discharge point north to 10th Street, and the installation of additional inlets and piping to collect stormwater from nearby streets. Contractor shall be responsible for, but not limited to: excavation and removal of current improvements as needed, grading and backfill, milling and paving, additional utility coordination, water main relocation at 6th & Rolla Streets, additional sanitary sewer main and lateral connections, traffic control and detours.

The successful Contractor shall be expected to proceed as expeditiously as possible upon receipt of the **NOTICE TO PROCEED** and complete the project by **May 1, 2027**. The anticipated date for the Notice to Proceed is **June 8, 2026**.

Incidental to this work will be coordination with other utility providers, testing per the specifications.

This bid will be awarded based on the total price of all of these items.

The City reserves the right to waive informalities in proposals and to reject any or all proposals or parts of proposals.

Payment shall be made for actual measured quantities.

Rolla Street Storm Sewer Improvements
Project 598
CITY OF ROLLA, MISSOURI
QUOTATION FORM

The estimated quantities below are to be used as estimates only. The City of Rolla reserves the right to add or delete quantities or locations.

Includes all labor, materials, and equipment necessary for constructing all improvements as directed at various locations throughout the community and as shown in these specifications.

Item No.	Description	Qty	Unit	Unit Price	Extended Total
1.	Mobilization	1	LS	\$	\$
2.	7 ft x 4 ft box culvert	704	LF	\$	\$
3.	6 ft x 4 ft box culvert	250	LF	\$	\$
4.	5 ft x 3 ft box culvert	283	LF	\$	\$
5.	4 ft x 3 ft box culvert	298	LF	\$	\$
6.	12 inch RCP pipe	60	LF	\$	\$
7.	15 inch RCP pipe	2,132	LF	\$	\$
8.	18 inch RCP pipe	818	LF	\$	\$
9.	21 inch RCP pipe	122	LF	\$	\$
10.	24 inch RCP pipe	487	LF	\$	\$
11.	27 inch RCP pipe	271	LF	\$	\$
12.	30 inch RCP pipe	274	LF	\$	\$
13.	8 inch Sanitary pipe	750	LF	\$	\$
14.	12 inch water main relocation	1	LS	\$	\$
15.	5 ft dia sanitary manholes	3	EA	\$	\$
16.	3x3 junction box	4	EA	\$	\$
17.	7x3 single inlet	14	EA	\$	\$
18.	7x3 double inlet	2	EA	\$	\$
19.	7x4 single inlet	15	EA	\$	\$
20.	7x5 single inlet	5	EA	\$	\$
21.	2x9 triple inlet	6	EA	\$	\$
22.	2x6 double inlet	3	EA	\$	\$
23.	2x3 single inlet	17	EA	\$	\$
24.	3x3 single inlet	4	EA	\$	\$
25.	2 ft curb & gutter	2,592	LF	\$	\$

26.	4 inch concrete sidewalk	12,433	SF	\$	\$
27.	6 inch concrete drive apron	2,029	SF	\$	\$
28.	Base Rock	7,672	SY	\$	\$
29.	3" Bit-base	1,424	TN	\$	\$
30.	2" BP-1	950	TN	\$	\$
31.	Temp. asphalt cold patch	50	TN	\$	\$
32.	Cast iron truncated domes	616	SF	\$	\$
33.	Sanitary Sewer tap	16	EA	\$	\$
34.	Temporary traffic control	1	LS	\$	\$
35.	Project Sign	1	LS	\$	\$
36.	Storm Sewer Abandonment	1	LS	\$	\$
TOTAL				\$	\$

Date _____ Address _____

Signature _____ City _____

Printed Name _____ State, Zip _____

Title _____ Phone _____

Firm _____ Fax _____

E-mail Address _____

Acknowledgment
of Addendum No. _____

GENERAL CONDITIONS OF THE CONTRACT FOR CONSTRUCTION

ARTICLE 1 CONTRACT DOCUMENTS

1.1 DEFINITION

1.1.1 THE CONTRACT DOCUMENTS

The Contract Documents consist of the City of Rolla-Contractor Agreement, the Conditions of the Contract (General, Supplementary and other Conditions), the Drawings, the Specifications, and all Addenda issued prior to and all Modifications issued after execution of the Contract. A Modification is (1) a written amendment to the Contract signed by both parties, (2) a Change Order, (3) a written interpretation issued by the Public Works Director pursuant to Subparagraph 2.2.8, or (4) a written order for a minor change in the Work issued by the Public Works Director pursuant to Paragraph 12.4. The Contract Documents do not include Bidding Documents such as the Advertisement or Invitation to Bid, the Instructions to Bidders, sample forms, the Contractor's Bid or portions of Addenda relating to any of these, or any other documents, unless specifically enumerated in the City of Rolla-Contractor Agreement.

1.1.2 THE CONTRACT

The Contract Documents form the Contract for Construction. This Contract represents the entire and integrated agreement between the parties hereto and supersedes all prior negotiations, representations, or agreements, either written or oral. The Contract may be amended or modified only by a Modification as defined in Subparagraph 1.1.1.

1.1.3 THE WORK

The Work comprises the completed construction required by the Contract Documents and includes all labor necessary to produce such construction, and all materials and equipment incorporated or to be incorporated in such construction.

1.1.4 THE PROJECT

The Project is the total construction of the Work performed under the Contract. Documents may be the whole or a part.

1.2 EXECUTION, CORRELATION AND INTENT

The Contract Documents shall be signed in not less than triplicate by the City of Rolla and Contractor. If either the City or the Contractor or both do not sign the Conditions of the Contract, Drawings, Specifications, or any of the other Contract Documents, the Public Works Director shall identify such Documents.

1.2.1 By executing the Contract Documents the Contractor represents that he has visited the site, familiarized himself with the local conditions under which the work is to be performed, and correlated his observations with the requirements of the Contract Documents.

1.2.2 The intent of the Contract Documents is to include all items necessary for the proper execution and completion of the Work. The Contract Documents are complementary, and what is required by any one shall be as binding as if required by all. Work not covered in the Contract Documents will not be required unless it is consistent therewith and is reasonably inferable therefrom as being necessary to produce the intended results. Words and abbreviations which have well-known technical or trade meanings are used in the Contract Documents in accordance with such recognized meanings.

1.2.3 The organization of the Specifications into divisions, sections and articles, and the arrangement of Drawings shall not control the Contractor in dividing the Work among Subcontractors or in establishing the extent of Work to be performed by any trade.

1.3 OWNERSHIP AND USE OF DOCUMENTS

1.3.1 All Drawings, Specifications and copies thereof furnished by the Public Works Director are and shall remain the property of the City. They are to be used with respect to this Project and are not to be used on any other project. Submission or distribution to meet official regulatory requirements or for other purposes in connection with the Project is not to be construed as publication in derogation of the City's common law copyright or other reserved rights.

ARTICLE 2
PUBLIC WORKS DIRECTOR

2.1 DEFINITION

2.1.1 The Public Works Director is the person lawfully licensed to practice engineering, or an entity lawfully practicing Engineering identified as such in the City of Rolla-Contractor Agreement, and is referred to throughout the Contract Documents as if singular in number and masculine in gender. The term Public Works Director means the Public Works Director or his authorized representative.

2.2 ADMINISTRATION OF THE CONTRACT

2.2.1 The Public Works Director will provide administration of the Contract as hereinafter described.

2.2.2 The Public Works Director will be the City's representative during construction and until final payment is due. The Public Works Director will advise and consult with appropriate City representatives. The City's instructions to the Contractor shall be forwarded through the Public Works Director. The Public Works Director will have authority to act on behalf of the city only to the extent provided in the Contract Documents.

2.2.3 The Public Works Director will visit the site at intervals appropriate to the stage of construction to monitor the progress and quality of the Work and to determine if the Work is proceeding in accordance with the Contract Documents. The Public Works Director will make on-site inspections to check the quality or quantity of the Work. On the basis of his on-site observations he will endeavor to guard the Owner against defects and deficiencies in the Work of the Contractor.

2.2.4 The Public Works Director will not be responsible for and will not have control or charge of construction means, methods, techniques, sequences or procedures, or for safety precautions and programs in connection with the Work, and he will not be responsible for the Contractor's failure to carry out the work in accordance with the Contract Documents. The Public Works Director will not be responsible for or have control or charge over the acts or omissions of the Contractor, Subcontractors, or any of their agents or employees, or any other persons performing any of the Work.

2.2.5 The Public Works Director shall at all times have access to the Work wherever it is in preparation and progress. The Contractor shall provide facilities for such access so the Public Works Director may perform his functions under the Contract Documents.

2.2.6 Based on the Public Works Director's observations and an evaluation of the Contractor's Applications for Payment, the Public Works Director will determine the amounts owed to the Contractor and will issue Certificates for Payment in such amounts, as provided in Paragraph 9.4.

2.2.7 The Public Works Director will be the interpreter of the requirements of the Contract Documents and the judge of the performance thereunder by both the City and Contractor.

2.2.8 The Public Works Director will render interpretations necessary for the proper execution or progress of the Work, with reasonable promptness and in accordance with any time limit agreed upon. Either party to the Contract may make written request to the Public Works Director for such interpretations.

2.2.9 Claims, disputes and other matters in question between the Contractor and the City relating to the execution or progress of the Work or the interpretation of the Contract Documents shall be referred initially to the Public Works Director for decision which he will render in writing within a reasonable time.

2.2.10 All interpretations and decisions of the Public Works Director shall be consistent with the intent of and reasonably inferable from the Contract Documents and will be in writing or in the form of drawings. In his capacity as interpreter and judge, he will endeavor to secure faithful performance by both the City and the Contractor, will not show partiality to either, and will not be liable for the result of any interpretation or decision rendered in good faith in such capacity.

2.2.11 The Public Works Director's decisions in matters relating to artistic effect will be final if consistent with the intent of the Contract Documents.

2.2.12 Any claim, dispute or other matter in question between the Contractor and the City referred to the Public Works Director, except those relating to artistic effect as provided in Subparagraph 2.2.11 and except those which have been waived by the making or acceptance of final payment as provided in Subparagraphs 9.9.4 and 9.9.5, shall be subject to arbitration upon the written demand of either party. However, no demand for arbitration of any such claim, dispute or other matter may be made until the earlier of (1) the date on which the Public Works Director has rendered a written decision, or (2) the tenth day after the parties have presented their evidence to the Public Works Director or have been given a reasonable opportunity to do so, if the Public Works Director has not rendered his written decision by that date. When such a written decision of the Public Works Director states (1) that the decision is final but subject to appeal, and (2) that any demand for arbitration of a claim, dispute or other matter covered by such decision must be made within thirty (30) days after the date on which the party making the demand receives the written decision, failure to demand arbitration within said thirty (30) day period will result in the Public Works Director's decision becoming final and binding upon the Public Works Director and the Contractor. If the Public Works Director renders a decision after arbitration proceedings have been initiated, such decision may be entered as evidence but will not supersede any arbitration proceedings unless the decision is acceptable to all parties concerned.

2.2.13 The Public Works Director will have authority to reject Work which does not conform to the Contract Documents. Whenever, in his opinion, he considers it necessary or advisable for the implementation of the intent of the Contract Documents, he will have

authority to require special inspection or testing of the Work in accordance with Subparagraph 7.7.2 whether or not such work be then fabricated, installed or completed. However, neither the Public Works Director's authority to act under this Subparagraph 2.2.13, nor any decision made by him in good faith either to exercise or not to exercise such authority, shall give rise to any duty or responsibility of the Public Works Director to the Contractor, any Subcontractor, any of their agents or employees, or any other person performing any of the Work.

2.2.14 The Public Works Director will review and approve or take other appropriate action upon Contractor's submittal such as Shop Drawings, Product Data and Samples, but only for conformance with the design concept of the Work and with the information given in the Contract Documents. Such action shall be taken with reasonable promptness so as to cause no delay. The Public Works Director's approval of a specific item shall not indicate approval of an assembly of which the item is a component.

2.2.15 The Public Works Director will prepare Change Orders in accordance with Article 12, and will have authority to order minor changes in the Work as provided in Subparagraph 12.4.1.

2.2.16 The Public Works Director will conduct inspections to determine the dates of substantial completion and final completion, will receive and forward to the City for the City's review written warranties and related documents required by the Contract and assembled by the Contractor, and will issue a final Certificate for Payment upon compliance with the requirements of Paragraph 9.9.

2.2.17 The Public Works Director will provide one or more Project Representatives to assist the Public Works Director in carrying out his responsibilities at the site. The duties, responsibilities and limitations of authority of any such Project Representative shall be as set forth in an exhibit to be incorporated in the Contract Documents.

**ARTICLE 3
CITY**

3.1 DEFINITION

3.1.1. The City is the entity identified as such in the City of Rolla – Contractor Agreement and is referred to throughout the Contract Documents as if singular in number and masculine in gender. The term City means the City of Rolla or its authorized representative.

3.2 INFORMATION AND SERVICES REQUIRED OF THE OWNER

3.2.1 The City shall, at the request of the Contractor, at the time of execution of the City of Rolla – Contractor Agreement, furnish to the Contractor reasonable evidence that he had made financial arrangements to fulfill his obligation under the Contract. Unless such reasonable evidence is furnished, the Contractor is not required to execute the City of Rolla Contractor Agreement or to commence the Work.

3.2.2. The City shall furnish all surveys describing the physical characteristics, legal limitations, utility locations, right-of-ways and easement for the site of the Project.

3.2.3 Rock grade shall be graded to $\pm .2'$. The Contractor will be required to finalize grade by cutting or filling with 1" clean crushed stone supplied by the City.

3.2.4 Except as provided in Subparagraph 4.7.1, the City shall secure and pay for necessary approvals, easements, assessments and charges required for the construction, use, or occupancy of permanent structures or for permanent changes in existing facilities.

3.2.5 Information or services under the City's control shall be furnished by the City with reasonable promptness to avoid delay in the orderly progress of the Work.

3.2.6 Unless otherwise provided in the Contract Documents, the Contractor will be furnished, free of charge, all copies of Drawings and Specifications reasonably necessary for the execution of the Work.

3.2.7 The City shall forward all instructions to the Contractor through the City Public Works Director.

3.2.8 The foregoing is in addition to other duties and responsibilities of the City enumerated herein and especially those in respect to Work by City or by Separate Contractors, Payments and Completion, and Insurance in Articles 6, 9 and 11 respectively.

3.3 CITY'S RIGHT TO STOP THE WORK

3.3.1 If the Contractor fails to correct defective Work as required by Paragraph 13.2 or persistently fails to carry out the Work in accordance with the Contract Documents, the City by a written order signed personally by the Mayor and Public Works Director, may order the Contractor to stop the Work, or any portion thereof, until the cause of such order has been eliminated; however, this right of the City to stop the Work shall not give rise to any duty on the part of the City to exercise this right for the benefit to the extent required by Subparagraph 6.1.3.

3.4 CITY'S RIGHT TO CARRY OUT THE WORK

3.4.1 If the Contractor defaults or neglects to carry out the Work in accordance with the Contract Documents and fails within seven days after receipt of written notice from the City to commence and continue correction of such default or neglect with diligence and promptness, the City may, after seven days following receipt by the Contractor of an additional written notice and without prejudice to any other remedy he may have, make good such deficiencies. In such case an appropriate Change Order shall be issued deducting from the payments then or thereafter due the Contractor the cost of correcting such deficiencies including compensation for the Public Works Director's office additional services made necessary by such default, neglect or failure. Such action by the City and the amount charged to the Contractor are both subject to the prior approval of the Public Works Director. If the payments then or thereafter due the Contractor are not sufficient to cover such amount, the Contractor shall pay the difference to the City.

ARTICLE 4 CONTRACTOR

4.1 DEFINITION

4.1.1 The Contractor is the person or entity identified as such in the City of Rolla-Contractor agreement and is referred to throughout the contract Documents as if singular in number and masculine in gender. The term Contractor means the Contractor or his authorized representative.

4.2 REVIEW OF CONTRACT DOCUMENTS

4.2.1 The Contractor shall carefully study and compare the Contract Documents and shall At once report to the Public Works Director any error, inconsistency or omission he may discover. The Contractor shall not be liable to the City or the Public works Director for any damage resulting from any such errors, inconsistencies or omissions in the Contract Documents. The Contractor shall perform no portion of the Work at any time without Contract Documents or, where required, approved Shop Drawings, Product Data or Samples for such portion of the work.

4.3 SUPERVISION AND CONSTRUCTION PROCEDURES

4.3.1 The Contractor shall supervise and direct the Work, using his best skill and attention. He shall be solely responsible for all construction means, methods, techniques, sequences and procedures and for coordinating all portions of the Work under the Contract.

4.3.2 The Contractor shall be responsible to the City for the acts and omissions of his employees, Subcontractors and their agents and employees, and other persons performing any of the Work under a contract with the Contractor.

4.3.3 The Contractor shall not be relieved from his obligations to perform the Work in accordance with the Contract Documents. Either by the activities or duties of the Public Works Director in his administration of the contract, or by inspections, tests or approvals required or performed under Paragraph 7.7 by persons other than the Contractor.

4.4 BEFORE FINAL PAYMENT-REQUIRED FINAL FORMS COMPLETION

4.4.1. Before final payment can be made, the general contractor and all subcontractors must file an **"Affidavit of Compliance"** form PW-4 (Enclosed in Special Conditions Section) with Public Works. The affidavit must state the contractor has fully complied with the Missouri Prevailing Wage Law, and Public Works must verify the correct wages were paid. No payment can be legally made by Public Works to the Contractor until the affidavit is filed in proper form and order with Public Works (See Sections 290.290 and 290.325, RSMo).

4.4.2. **Contractor's Affidavit regarding Settlement of Claims** must be completed by the Contractor and returned to Public Works before final payment can be made to the Contractor. This form can be found at the end of Special Conditions in these specifications.

4.5 LABOR AND MATERIALS

4.5.1 Unless otherwise provided in the Contract Documents, the contractor shall provide and pay for all labor, materials, equipment, tools, construction equipment and machinery, water, heat utilities, transportation, and other facilities and services necessary for the proper execution and completion of the Work whether temporary or permanent and whether or not incorporated or to be incorporated in the Work.

4.5.2 The Contractor shall at all times enforce strict discipline and good order among his employees and shall not employ on the Work any unfit person or anyone not skilled in the task assigned to him.

4.6 WARRANTY

4.6.1 The Contractor warrants to the City and the Public Works Director that all materials and equipment furnished under this Contract will be new unless otherwise specified, and that all Work will be of good quality, free from faults and defects and in conformance with the Contract Documents. All Work not conforming to these requirements, including substitutions not properly approved and authorized, may be considered defective. If required by the Public Works Director, the Contractor shall furnish satisfactory evidence as to the kind and quality of materials and equipment. This warranty is not limited by the provisions of Paragraph 13.2.

4.7 TAXES

4.7.1 Missouri State Statutes 144.062, effective April 28, 1994, allows for a sales tax exemption to contractors constructing, repairing or remodeling facilities or purchasing personal property and materials to be incorporated into and consumed in the construction of projects for a tax exemption entity. The tax entity shall furnish a signed exemption certificate authorizing such purchases for the construction, repair or remodeling project to each contractor and/or subcontractor. For further information please contact the Department of Public Works, Telephone (573) 364-8659. A form approved by the Department of Public Works will be provided upon request.

4.8 PERMITS, FEES AND NOTICES

4.8.1 Unless otherwise provided in the Contract Documents, the Contractor shall secure and pay for the building permit and for all other permits and governmental fees, licenses and inspections necessary for the proper execution and completion of the Work which are

customarily secured after execution of the Contract and which are legally required at the time the bids are received.

4.8.2 The Contractor shall give all notices and comply with all laws, ordinances, rules, regulations and lawful orders of any public authority bearing on the performance of the Work.

4.8.3 It is not the responsibility of the Contractor to make certain that the Contract Documents are in accordance with applicable laws, statutes, building codes and regulations. If the Contractor observes that any of the Contract Documents are at variance therewith in any respect, he shall promptly notify the Public Works Director in writing, and any necessary changes shall be accomplished by appropriate Modification.

4.8.4 If the Contractor performs any Work knowing it to be contrary to such laws, ordinances, rules and regulation, and without such notice to the Public Works Director, he shall assume full responsibility therefore and shall bear all costs attributable thereto.

4.9 ALLOWANCES

4.9.1 The Contractor shall include in the Contract Sum all allowances stated in the Contract Documents. Items covered by these allowances shall be supplied for such amounts and by such persons as the City may direct, but the Contractor will not be required to employ persons against whom he makes a reasonable objection.

4.9.2. Unless otherwise provided in the Contract Documents: (.1) these allowances shall cover the cost to the Contractor, less any applicable trade discount, of the materials and equipment required by the allowance delivered at the site, and all applicable taxes; (.2) the Contractor's costs for unloading and handling on the site, labor, installation costs, overhead, profit and other expenses contemplated for the original allowance shall be included in the contract Sum and not in the allowance; (.3) whenever the cost is more than or less than the allowance, the Contract Sum shall be adjusted accordingly by Change Order, the amount of which will recognize changes, if any, in handling costs on the site, labor, installation costs, overhead, profit and other expenses.

4.10 SUPERINTENDENT

4.10.1 The Contractor shall employ a competent superintendent and necessary assistants who shall be in attendance at the Project site during the progress of the Work. The superintendent shall represent the Contractor and all communications given to the superintendent shall be as binding as if given to the Contractor. Important communications shall be confirmed in writing. Other communication shall be so confirmed on written request in each case.

4.11 PROGRESS SCHEDULE

4.11.1 The Contractor, immediately after being awarded the Contract, shall prepare and submit for the City and Public Works Director's information an estimated progress schedule for the Work. The progress schedule shall be related to the entire Project to the

extent required by the Contract Documents, and shall provide for expeditious and practicable execution of the Work.

4.12 DOCUMENTS AND SAMPLES AT THE SITE

4.12.1 The Contractor shall maintain at the site for the City one record copy of all Drawings, Specifications, Addenda, Change Orders and other Modifications, in good order and marked currently to record all changes made during construction, and approved Shop Drawings, Product Data and Samples. These shall be available to the Public Works Director and shall be delivered to him for the City upon completion of the Work.

4.13 SHOP DRAWINGS, PRODUCT DATA AND SAMPLES

4.13.1 Shop Drawings are drawings, diagrams, schedules and other data specially prepared for the Work by the Contractor or any Subcontractor, manufacturer, supplier or distributor to illustrate some portion of the Work.

4.13.2 Product Data are illustrations, standard schedules, performance charts, instructions, brochures, diagrams and other information furnished by the Contractor to illustrate a material, product or system for some portion of the Work.

4.13.3 Samples are physical examples that illustrate materials, equipment or workmanship and establish standards by which the Work will be judged.

4.13.4 The Contractor shall review, approve and submit, with reasonable promptness and in such sequence as to cause no delay in the Work or in the work of the Owner or any separate Contractor, all Shop Drawings, Product Data and Samples required by the Contract Documents.

4.13.5 By approving and submitting Shop Drawings, Product Data and Samples, the Contractor represents that he has determined and verified all materials, field measurements, and field construction criteria related thereto, or will do so, and that he has checked and coordinated the information contained within such submittals with the requirements of the Work and of the Contract Documents.

4.13.6 The Contractor shall not be relieved of responsibility for any deviation from the requirements of the Contract Documents by the Public Works Director's approval of Shop Drawings, Product Data or Samples under Subparagraph 2.2.14 unless the Contractor has specifically informed the Engineer in writing of such deviation at the time of submission and the Public Works Director has given written approval to the specific deviation. The Contractor shall not be relieved from responsibility for errors or omissions in the Shop Drawings, Product Data or Samples by the Public Works Director's approval thereof.

4.13.7 The Contractor shall direct specific attention, in writing or on resubmitted Shop Drawings, Product Data or Samples, to revisions other than those requested by the Public Works Director on previous submittals.

4.13.8 No portion of the Work requiring submission of a Shop Drawing, Product Data or Sample shall be commenced until the submittal has been approved by the Public Works Director as provided in Subparagraph 2.2.14. All such portions of the Work shall be in accordance with approved submittals.

4.14 USE OF SITE

4.14.1 The Contractor shall confine operations at the site to areas permitted by law, ordinances, permits and the Contract Documents and shall not unreasonably encumber the site with any materials or equipment.

4.15 CUTTING AND PATCHING OF WORK

4.15.1 The Contractor shall be responsible for all cutting, fitting or patching that may be required to complete the Work or to make its several parts fit together properly.

4.15.2 The Contractor shall not damage or endanger any portion of the Work or the work of the city or any separate Contractors by cutting, patching or otherwise altering any work, or by excavation. The Contractor shall not cut or otherwise alter the work of the City or any separate Contractor except with the written consent of the City and of such separate Contractor. The Contractor shall not unreasonably withhold from the City or any separate Contractor his consent to cutting or otherwise altering the Work.

4.16 CLEANING UP

4.16.1 The Contractor at all times shall keep the construction site free from accumulation of waste materials or rubbish caused by his operations. At the completion of the work he shall remove all his waste materials and rubbish from and about the Project as well as all his tools, construction equipment, machinery and surplus materials.

4.16.2 If the Contractor fails to clean up at the completion of the Work, the City may do so as provided in Paragraph 3.4 and the cost thereof shall be charged to the Contractor.

4.17 COMMUNICATIONS

4.17.1 The Contractor shall forward all communications to the City through the Public Works Director.

4.18 ROYALTIES AND PATENTS

4.18.1 The Contractor shall pay all royalties and license fees. He shall defend all suits or claims for infringement of any patent rights and shall save the City harmless from loss on account thereof, except that the City shall be responsible for all such loss when a particular design, process or the product of a particular manufacturer or manufacturers is specified, but if the Contractor has reason to believe that the design, process or product specified is an infringement of a patent, he shall be responsible for such loss unless he promptly gives such information to the Public Works Director.

4.19 INDEMNIFICATION

4.19.1 To the fullest extent permitted by law, the Contractor shall indemnify and hold harmless the City and the Public Works Director and their agents and employees from and against all claims, damages, losses and expenses, including but not limited to attorney's fees, arising out of or resulting from the performance of the Work, provided that any such claim, damage, loss or expense (.1) is attributable to bodily injury, sickness, disease or death, or to injury to or destruction of tangible property (other than the Work itself) including the loss of use resulting therefrom, and (.2) is caused in whole or in part by any negligent act or omission of the Contractor, any Subcontractor, anyone directly or indirectly employed by any of them or anyone for whose acts any of them may be liable,

regardless of whether or not it is caused in part by a party indemnified hereunder. Such obligation shall not be construed to negate, abridge, or otherwise reduce any other right or obligation of indemnity which would otherwise exist as to any party or person described in Paragraph 4.18.

4.19.2 In any and all claims against the City or Public Works Director or any of their agents or employees by any employee of the Contractor, any Subcontractor or anyone directly or indirectly employed by any of the above or anyone for whose acts any of them may be liable, the indemnification obligation under this Paragraph 4.18 shall not be limited in any way by any limitation on the amount or type of damages, compensation or benefits payable by or for the Contractor or any Subcontractor under workers' or worker's compensation acts, disability benefit acts or other employee benefit acts.

4.19.3 The obligations of the Contractor under this Paragraph 4.18 shall not extend to the liability of the Public Works Director, his agents or employees, arising out of (.1) the preparation or approval of maps, drawings, opinions, reports, surveys, change orders, designs or specifications, or (.2) the giving of or the failure to give directions or instruction by the Public Works Director, his agents or employees provided such giving or failure to give is the primary cause of the injury or damage.

ARTICLE 5 SUBCONTRACTORS

5.1 DEFINITION

5.1.1. A Subcontractor is a person or entity who has a direct contract with the Contractor to perform any of the Work at the site. The term Subcontractor is referred to throughout the Contract Documents as if singular in number and masculine in gender and means a Subcontractor or his authorized representative. The term Subcontractor does not include any separate Contractor or his subcontractors.

5.1.2 A Sub-subcontractor is a person or entity who has a direct or indirect contract with a Subcontractor to perform any of the Work at the site. The term Sub-subcontractor is referred to throughout the Contract Documents as if singular in number and masculine in gender and means a Sub-subcontractor or an authorized representative thereof.

5.2 AWARD OF SUBCONTRACTORS AND OTHER CONTRACTS FOR PORTIONS OF THE WORK

5.2.1 Unless otherwise required by Contract Documents or the Bidding Documents, the Contractor, as soon as practicable after the award of the Contract, shall furnish to the Public Works Director in writing the names of the persons or entities (including those who are to furnish materials or equipment fabricated to a special design) proposed for each of the principal portions of the Work. The Public Works Director will promptly reply to the Contractor in writing stating whether or not the City or the Public Works Director after due investigation, has reasonable objection to any such proposed person or entity. Failure of the City or Public Works Director to reply promptly shall constitute notice of no reasonable objection.

5.2.2 The Contractor shall not contract with any such proposed person or entity to whom the City or the Public Works Director has made reasonable objection under the provisions of Subparagraph 5.2.1. The Contractor shall not be required to contract with anyone to whom he has reasonable objection.

5.2.3 If the City or the Public Works Director has reasonable objection to any such proposed person or entity, the Contractor shall submit a substitute to whom the City or the Public Works Director has no reasonable objection, and the Contract Sum shall be increased or decreased by the difference in cost occasioned by such substitution and an appropriate Change Order shall be issued; however, no increase in the Contract Sum shall be allowed for any such substitution unless the Contractor has acted promptly and responsibly in submitting names as required by Subparagraph 5.2.1.

5.2.4 The Contractor shall make no substitution for any Subcontractor, person or entity previously selected if the City or Public Works Director makes reasonable objection to such substitution.

5.3 SUBCONTRACTUAL RELATIONS

5.3.1 By an appropriate agreement, written where legally required for validity, the Contractor shall require each Subcontractor, to the extent of the Work to be performed by the Subcontractor, to be bound to the Contractor by the terms of the Contract Document, and to assume toward the Contractor all the obligations and responsibilities which the Contractor, by these Documents, assumes toward the City and the Public Works Director. Said agreement shall preserve and protect the rights of the City and the Public Works Director under the Contract Documents with respect to the Work to be performed by the Subcontractor so that the subcontracting thereof will not prejudice such rights, and shall allow to the Subcontractor, unless specifically provided otherwise in the Contractor-Subcontractor agreement, the benefit of all rights, remedies and redress against the Contractor that the Contractor, by these Documents, has against the City. Where appropriate, the Contractor shall require each Subcontractor to enter into similar agreements with his Sub-subcontractors. The Contractor shall make available to each proposed Subcontractor, prior to the execution of the Subcontract, copies of the Contract Documents to which the Subcontractor will be bound by this Paragraph 5.3, and identify to the Subcontractor any terms and conditions of the proposed Subcontract which may be at variance with the Contract Documents. Each Subcontractor shall similarly make copies of such Documents available to his Sub-subcontractors.

ARTICLE 6
WORK BY CITY OR BY SEPARATE CONTRACTORS

6.1 CITY'S RIGHT TO PERFORM WORK AND TO AWARD SEPARATE CONTRACTS

6.1.1 The City reserves the right to perform work related to the Project with his own forces, and to award separate contracts in connection with other portions of the Project or other work on the site under these or similar Conditions of the contract. If the Contractor claims that delay or additional cost is involved because of such action by the City, he shall make such claim as provided elsewhere in the Contract Documents.

6.1.2 When separate contracts are awarded for different portions of the Project or other work on the site, the term Contractor in the Contract Documents in each case shall mean the Contractor who executes each separate City of Rolla Contractor Agreement.

6.1.3 The City will provide for the coordination of the work of his own forces and of each separate Contractor with the Work of the Contractor, who shall cooperate therewith as provided in Paragraph 6.2.

6.2 MUTUAL RESPONSIBILITY

6.2.1 The Contractor shall afford the City and separate Contractors reasonable opportunity for the introduction and storage of their materials and equipment and the execution of their work, and shall connect and coordinate his Work with theirs as required by the Contract Documents.

6.2.2 If any part of the Contractor's Work depends for proper execution or results upon the work of the City or any separate Contractor, the Contractor shall, prior to proceeding with the Work, promptly report to the Public Works Director any apparent discrepancies or defects in such other work that renders it unsuitable for such proper execution and results. Failure of the Contractor so to report shall constitute an acceptance of the City or separate Contractor's work as fit and proper to receive his Work, except as to defects which may subsequently become apparent in such work by others.

6.2.3 Any costs caused by defective or ill-timed work shall be borne by the party responsibly therefore.

6.2.4 Should the Contractor wrongfully cause damage to the work or property of the City, or to other work on the site, the Contractor shall promptly remedy such damage as provided in Subparagraph 10.2.5.

6.2.5 Should the Contractor wrongfully cause damage to the work or property of any separate Contractor, the Contractor shall upon due notice promptly attempt to settle with such other Contractor by agreement, or otherwise to resolve the dispute. If such separate Contractor sues or initiates an arbitration proceeding against the City on account of any damage alleged to have been caused by the Contractor, the City shall notify the

Contractor who shall defend such proceedings at the City's expense, and if any judgment or award against the City arises therefrom the Contractor shall pay or satisfy it and shall reimburse the City for all attorneys' fees and court or arbitration costs which the City has incurred.

6.3 CITY'S RIGHT TO CLEAN UP

6.3.1 If a dispute arises between the Contractor and separate Contractors as to their responsibility for cleaning up as required by Paragraph 4.15, the City may clean up and charge the cost thereof to the Contractors responsible therefore as the Public Works Director shall determine to be just.

**ARTICLE 7
MISCELLANEOUS PROVISIONS**

7.1 GOVERNING LAW

7.1.1 The Contract shall be governed by the law of the place where the Project is located.

7.2 SUCCESSORS AND ASSIGNS

7.2.1. The City and the Contractor each binds himself, his partners, successors, assigns and legal representatives to the other party hereto and to the partners, successors, assigns and legal representatives of such other party in respect to all covenants, agreements and obligations contained in the Contract Documents. Neither party to the Contract shall assign the Contract or sublet it as a whole without the written consent of the other, nor shall the Contractor assign any moneys due to him hereunder, without the previous written consent of the City.

7.3 WRITTEN NOTICE

7.3.1 Written notice shall be deemed to have been duly served if delivered in person to the individual or member of the firm or entity or to an officer of the corporation for whom it was intended, or if delivered at or sent by registered or certified mail to the last business address known to him who gives the notice.

7.4 CLAIMS FOR DAMAGE

7.4.1 Should either party to the Contract suffer injury or damage to person or property because of any act or omission of the other party or of any of his employees, agents or others for whose acts he is legally liable, claim shall be made in writing to such other party within a reasonable time after the first observance of such injury or damage.

7.5 PERFORMANCE BOND AND LABOR AND MATERIAL PAYMENT BOND

7.5.1 The City shall have the right to require the Contractor to furnish bonds covering the faithful performance of the Contract and the payment of all obligations arising thereunder if and as required in the Bidding Documents or in the Contract Documents.

7.6 RIGHTS AND REMEDIES

7.6.1 The duties and obligations imposed by the Contract Documents and the rights and remedies available thereunder shall be in addition to and not a limitation of any duties, obligations, rights and remedies otherwise imposed or available by law.

7.6.2 No action or failure to act by the City, Public Works Director or Contractor shall constitute a waiver of any right or duty afforded any of them under the Contract, nor shall

any such action or failure to act constitute an approval of nor acquiescence in any breach thereunder, except as may be specifically agreed in writing.

7.7 TESTS

7.7.1 If the Contract Documents, laws, ordinances, rules, regulations or orders of any other public authority having jurisdiction require any portion of the Work to be inspected, tested or approved, the Contractor shall give the Public Works Director timely notice of its readiness so the Public Works Director may observe such inspection, testing or approval. The Contractor shall bear all costs of such inspections, tests or approvals conducted by other public authorities. Unless otherwise provided, the City shall bear all costs of other inspections, tests, or approvals.

7.7.2 If the City determines that any Work requires special inspection, testing, or approval which Subparagraph 7.7.1 does not include, he will instruct the Contractor to order such special inspection, testing or approval, and the Contractor shall give notice as provided in Subparagraph 7.7.1. If such special inspection or testing reveals a failure of the Work to comply with the requirements of the Contract Documents, the Contractor shall bear all costs thereof, otherwise the City shall bear such costs, and an appropriate Change Order shall be issued.

7.7.3 Required certificates of inspection, testing or approval shall be secured by the Contractor and promptly delivered by him to the Public Works Director.

7.7.4 The Public Works Director is to observe the inspections, tests or approvals required by the Contract Documents. He will do so promptly and, where practicable, at the source of supply.

7.8 INTEREST

7.8.1 Payments due and unpaid under the Contract Document shall bear interest from thirty (30) days of due date. Payment is due at such rate as the parties may agree upon in writing or, in the absence thereof, at the legal rate prevailing at the place of the Project.

7.9 ARBITRATION

7.9.1 All claims, disputes and other matters in question between the Contractor and the City arising out of, or relating to, the Contract Documents or the breach thereof, except as provided in Subparagraph 2.2.11 with respect to the Public Works Director's decisions on matters relating to artistic effect, and except for claims which have been waived by the making or acceptance of final payment as provided by Subparagraphs 9.9.5, shall be decided by arbitration in accordance with the Construction Industry Arbitration Rules of the American Arbitration Association unless the parties mutually agree otherwise. No arbitration arising out of or relating to the Contract Documents shall include, by consolidation, joinder or in any other manner, the Public Works Director, his employees or consultants except by written consent containing a specific reference to the City of Rolla Contractor Agreement and signed by the Public Works Director, the City, the Contractor and any other person sought to be joined. No arbitration shall include by consolidation,

joiner or in any other manner, parties other than the City, the Contractor and any other persons substantially involved in a common question of fact or law, whose presence is required if complete relief is to be accorded in the arbitration. No person other than the City or Contractor shall be included as an original third party or additional third party to an arbitration whose interest or responsibility is insubstantial. Any consent to arbitration involving an additional person or persons shall not constitute consent to arbitration of any dispute not described therein or with any person not named or described therein. The foregoing agreement to arbitrate and any other agreement to arbitrate with an additional person or persons duly consented to by the parties to the City of Rolla Contractor Agreement shall be specifically enforceable under the prevailing arbitration law. The award rendered by the arbitrators shall be final, and judgment may be entered upon it in accordance with applicable law in any court having jurisdiction thereof.

7.9.2 Notice of the demand of arbitration shall be filed in writing with the other party of the City of Rolla-Contractor Agreement and with the American Arbitration Association, and a copy shall be filed with the Public Works Director. The demand for arbitration shall be made within the time limits specified in Subparagraph 2.2.12 where applicable, and in all other cases within a reasonable time after the claim, dispute or other matter in question has arisen, and in no event shall it be made after the date when institution of legal or equitable proceedings based on such claim, dispute or other matter in question would be barred by the applicable statute of limitations.

7.9.3 Unless otherwise agreed in writing, the Contractor shall carry on the Work and maintain its progress during any arbitration proceedings, and the City shall continue to make payments to the Contractor in accordance with the Contract Documents.

7.10 BUY AMERICA POLICY

Any manufactured goods or commodities used or supplied in the performance of this contract or any subcontract thereto shall be manufactured or produced in the United States as required in Section 34.353, R.S.Mo.

ARTICLE 8 TIME

8.1 DEFINITIONS

8.1.1 The date of commencement of the Work is the date established in a notice to proceed. If there is no notice to proceed, it shall be the date of the City of Rolla-Contractor Agreement or such other date as may be established therein.

8.1.2 The Date of Substantial Completion of the Work or designated portion thereof is the Date certified by the Public Works Director when construction is sufficiently complete in accordance with the Contract Documents, so the City can occupy or utilize the Work or designated portion thereof for the use for which it is intended.

8.1.3 The term day as used in the Contract Documents shall mean calendar day unless otherwise specifically designated.

8.2 PROGRESS AND COMPLETION

8.2.1 All time limits stated in the Contract Documents are of the essence of the Contract.

8.2.2 The Contractor shall begin the Work on the date of commencement as defined in Subparagraph 8.1.2. He shall carry the Work forward expeditiously with adequate forces and shall achieve Substantial Completion within the Contract Time.

8.3 DELAYS AND EXTENSIONS OF TIME

8.3.1 If the Contractor is delayed at any time in the progress of the Work by any act or neglect of the City or the Public Works Director, or by any employee of either, or by any separate Contractor employed by the City or by changes ordered in the Work, or by labor disputes, fire, unusual delay in transportation, adverse weather conditions not reasonably anticipatable, unavoidable casualties, or any causes beyond the Contractor's control, or by delay authorized by the City pending arbitration, or by any other cause which the Public Works Director determines may justify the delay, then the Contract Time shall be extended by Change Order for such reasonable time as the Public Works Director may determine.

8.3.2 Any claim for extension of time shall be made in writing to the Public Works Director not more than twenty (20) days after the commencement of the delay; otherwise it shall be waived. In the case of a continuing delay only one claim is necessary. The Contractor shall provide an estimate of the probable effect of such delay on the progress of the Work.

8.3.3 If no agreement is made stating the dates upon which interpretations as provided in Subparagraph 2.2.8 shall be furnished, then no claim for delay shall be allowed on

account of failure to furnish such interpretations until fifteen (15) days after written request is made for them, and not then unless such claim is reasonable.

8.3.4 This Paragraph 8.3 does not exclude the recovery of damages for delay by either party under other provisions of the Contract Documents.

**ARTICLE 9
PAYMENTS AND COMPLETION**

9.1 CONTRACT SUM

9.1.1 The Contract Sum is stated in the City of Rolla-Contractor Agreement and, including authorized adjustments thereto, is the total amount payable by the City to the Contractor for the performance of the Work under the Contract Documents.

9.2 SCHEDULE OF VALUES

9.2.1 Before the first Application for Payment, the Contractor shall submit to the Public Works Director a schedule of values allocated to the various portions of the Work, prepared in such form and supported by such data to substantiate its accuracy as the Public Works Director may require. This Schedule, unless objected to by the Public Works Director, shall be used only as a basis for the Contractor's Applications for Payment.

9.3 APPLICATIONS FOR PAYMENT

9.3.1 At least ten (10) days before the date for each progress payment established in the City of Rolla-Contractor Agreement, the Contractor shall submit to the Public Works Director an itemized Application for Payment, supported by data substantiating the Contractor's right to payment as the Public Works Director will require.

9.3.2 Unless otherwise provided in the Contract Documents, payments will be made on account of materials or equipment not incorporated in the Work but delivered and suitably stored at the site and, if approved in advance by the City, payments may similarly be made for materials or equipment suitably stored at some other location agreed upon in writing. Payments for materials or equipment stored on or off the site shall be conditioned upon submission by the Contractor of bills of sale or such other procedures satisfactory to the City to establish the City's title to such materials or equipment or otherwise protect the City's interest, including applicable insurance and transportation to the site for those materials and equipment stored off the site.

9.3.3 The Contractor warrants that title to all Work, materials and equipment covered by an Application for Payment will pass to the City either by incorporation in the construction or upon the receipt of payment by the Contractor, whichever occurs first, free and clear of all liens, claims, security interests or encumbrances, hereinafter referred to in this Article 9 as "liens"; and that no Work, materials or equipment covered by an Application for Payment will have been acquired by the Contractor, or by any other person performing Work at the site or furnishing materials and equipment for the Project, subject to an agreement under which an interest therein or an encumbrance thereon is retained by the seller or otherwise imposed by the Contractor or such other person.

9.4 CERTIFICATES FOR PAYMENT

9.4.1 The Public Works Director will, within seven (7) days after the receipt of the Contractor's Application for Payment, either issue a Certificate for Payment to the City, with a copy to the Contractor for such amount as the Public Works Director determines is properly due or notify the Contractor in writing his reasons for withholding a Certificate as provided in Subparagraph 9.6.1.

9.4.2 The issuance of a Certificate for Payment will constitute a representation by the Public Works Director to the City, based on his observations at the site as provided in Subparagraph 2.2.3 and the data comprising the Application for Payment, that the Work has progressed to the point indicated; that, to the best of his knowledge information and belief, the quality of the Work is in accordance with the Contract Documents (subject to an evaluation of the Work for conformance with the contract Documents upon Substantial Completion, to the results of any subsequent tests required by or performed under the Contract Documents, to minor deviations from the Contract Documents correctable prior to completion, and to any specific qualifications stated in his Certificate); and that the Contractor is entitled to payment in the amount certified. However, by issuing a Certificate for Payment, the Public Works Director shall not thereby be deemed to represent that he has made exhaustive or continuous on-site inspections to check the quality or quantity of the Work or that he has reviewed the construction means, methods, techniques, sequences, or procedures, or that he has made any examination to ascertain how or for what purpose the Contractor has used the moneys previously paid on account of the Contract Sum.

9.5 PROGRESS PAYMENTS

9.5.1 After the Public Works Director has issued a Certificate for Payment, the City shall make payment in the manner and within the time provided in the Contract Documents.

9.5.2 The Contractor shall promptly pay each Subcontractor, upon receipt of payment from the City, out of the amount paid to the Contractor on account of such Subcontractor's Work, the amount to which the Subcontractor is entitled, reflecting the percentage actually retained, if any, from payment to the Contractor on account of such Subcontractor's Work. The Contractor shall, by an appropriate agreement with each Subcontractor, require each Subcontractor to make payments to his Subcontractors in similar manner.

9.5.3 The Public Works Director may, on request and at his discretion, furnish to any Subcontractor, if practicable, information regarding the percentages of completion or the amounts applied for by the Contractor and the action taken thereon by the Public Works Director on account of Work done by such Subcontractor.

9.5.4 Neither the City nor the Public Works Director shall have any obligations to pay or to see to the payment of any moneys to any Subcontractor except as may otherwise be required by law.

9.5.5 No Certificate for a progress payment, nor any partial or entire use or occupancy of the Project by the City shall constitute an acceptance of any Work not in accordance with the Contract Documents.

9.6 PAYMENTS WITHHELD

9.6.1. The Public Works Director may decline to certify payment and may withhold his Certificate in whole or in part to the extent necessary reasonably to protect the City, if in his opinion he is unable to make representations to the City as provided in Subparagraph 9.4.2. If the Public Works Director is unable to make representations to the City as provided in Subparagraph 9.4.2 and to certify payment in the amount of the Application, he will notify the Contractor as provided in Subparagraph 9.4.1. If the Contractor and the Public Works Director cannot agree on a revised amount, the Public Works Director will promptly issue a Certificate for Payment for the amount for which he is able to make such representations to the City. The Public Works Director may also decline to certify payment or, because of subsequently discovered evidence or subsequent observations, he may nullify the whole or any part of any Certificate for Payment previously issued, to such extent as may be necessary in his opinion to protect the City from loss because of:

- .1 defective Work not remedied,
- .2 third party claims filed or reasonable evidence indicating probable filing of such claims,
- .3 failure of the Contractor to make payments properly to Subcontractors or for labor, materials or equipment,
- .4 reasonable evidence that the Work cannot be completed for the unpaid balance of the Contract Sum,
- .5 damage to the City or another Contractor,
- .6 reasonable evidence that the Work will not be completed within the Contract time, or
- .7 persistent failure to carry out the Work in accordance with the Contract Document.

9.6.2 When the above grounds in Subparagraph 9.6.1 are removed, payment shall be made for amounts withheld because of them.

9.6.3 In the event that the Missouri Department of Labor and Industrial Relations has determined that a violation of Section 292.675, R.S.Mo, has occurred and the at penalty as described in Section 10.4.1 shall be assessed, the City shall withhold and retain all

sums and amounts due and owing when making payments to Contractor under this Contract.

9.7 FAILURE OF PAYMENT

9.7.1 If the Public Works Director does not issue a Certificate for Payment, through no fault of the Contractor, within seven (7) days after receipt of the Contractor's Application for Payment, or if the City does not pay the Contractor within thirty (30) days after the date established in the Contract Documents any amount certified by the Public Works Director or awarded by arbitration, then the Contractor may, upon seven (7) additional days' written notice to the City and the Public Works Director, stop the Work until payment of the amount owing has been received. The Contract Sum shall be increased by the amount of the Contractor's reasonable costs of shut-down, delay and start-up, which shall be effected by appropriate Change Order in accordance with Paragraph 12.3.

9.8 SUBSTANTIAL COMPLETION

9.8.1 When the Contractor considers that the Work, or a designated portion thereof which is acceptable to the City, is substantially complete as defined in Subparagraph 8.1.3, the Contractor shall prepare for submission to the Public Works Director a list of items to be completed or corrected. The failure to include any items on such list does not alter the responsibility of the Contractor to complete all Work in accordance with the Contract Documents. When the Public Works Director on the basis of an inspection determines that the Work or designated portion thereof is substantially complete, he will then prepare a Certificate of Substantial Completion, which shall establish the Date of Substantial Completion, shall state the responsibilities of the City and the Contractor for security, maintenance, utilities, damage to the Work, and insurance, and shall fix the time within which the Contractor shall complete the items listed therein. Warranties required by the Contract Documents shall commence on the date of Substantial Completion of the work or designated portion thereof unless otherwise provided in the Certificate of Substantial Completion. The Certificate of Substantial Completion shall be submitted to the City and the Contractor for their written acceptance of the responsibilities assigned to them in such Certificate.

9.8.2 Upon Substantial Completion of the Work or designated portion thereof and upon application by the Contractor and certification by the Public Works Director, the Owner shall make payment, reflecting adjustment in retainage, for such Work or portion thereof, as provided in the Contract Documents.

9.9 FINAL COMPLETION AND FINAL PAYMENT

9.9.1 Upon receipt of written notice that the Work is ready for final inspection and acceptance and upon receipt of a final Application for Payment, the Public Works Director will promptly make such inspection and, when he finds the Work acceptable under the Contract Documents and the Contract fully performed, he will promptly issue a final Certificate for Payment stating that to the best of his knowledge, information and belief, and on the basis of his observations and inspections, the Work has been completed

in accordance with the terms and conditions of the contract Documents and that the entire balance found to be due the Contractor, and noted in said final Certificate, is due and payable. The Public Works Director's final Certificate for Payment will constitute a further representation that the conditions precedent to the Contractor's being entitled to final payment as set forth in Subparagraph 9.9.2 have been fulfilled.

9.9.2 Neither the final payment nor the remaining retained percentage shall become due until the Contractor submits to the Public Works Director (1) an affidavit that all payrolls, bills for materials and equipment, and other indebtedness connected with the Work for which the City or his property might in any way be responsible, have been paid or otherwise satisfied, (2) consent of surety, if any, to final payment and (3) if required by the City other data establishing payment or satisfaction of all such obligations, such as receipts, releases and waivers of liens arising out of the contract, to the extent and in such form as may be designated by the City. If any Subcontractor refuses to furnish a release or waiver required by the City, the Contractor may furnish a release or waiver required by the City, the Contractor may furnish a bond satisfactory to the City to indemnify him against any such lien. If any such lien remains unsatisfied after all payments are made, the Contractor shall refund to the City all moneys that the latter may be compelled to pay in discharging such lien, including all costs and reasonable attorneys' fees.

9.9.3 If, after Substantial Completion of the Work, final completion thereof is materially delayed through no fault of the Contractor or by the issuance of Change Orders affecting final completion, and the Public Works Director so confirms, the City shall, upon application by the Contractor and certification by the Public Works Director, and without terminating the Contract, make payment of the balance due for that portion of the Work fully completed and accepted. If the remaining balance for Work not fully completed or corrected is less than the retainage stipulated in the Contract Documents, and if bonds have been furnished as provided in Paragraph 7.5, the written consent of the surety to the payment of the balance due for that portion of the Work fully completed and accepted shall be submitted by the Contractor to the Public Works Director prior to certification of such payment. Such payment shall be made under the terms and conditions governing final payment, except that it shall not constitute a waiver of claims.

9.9.4 The making of final payment shall constitute a waiver of all claims by the City except those arising from:

- .1 unsettled liens,
- .2 faulty or defective Work appearing after Substantial Completion,
- .3 failure of the Work to comply with the requirements of the Contract Document, or
- .4 terms of any special warranties required by the Contract Documents.

9.9.5 The acceptance of final payment shall constitute a waiver of all claims by the Contractor except those previously made in writing and identified by the Contractor as unsettled at the time of the final Application for Payment. Any payment however, final

or otherwise, shall not release the Contractor or its sureties from any obligation under the contract documents or the performance bonds.

**ARTICLE 10
PROTECTION OF PERSONS AND PROPERTY**

10.1 SAFETY PRECAUTIONS AND PROGRAMS

10.1.1 The Contractor shall be responsible for initiating, maintaining and supervising all safety precautions, signs, barricades and programs in connection with the work.

10.2 SAFETY OF PERSONS AND PROPERTY

10.2.1 The Contractor shall take all reasonable precautions for the safety of, and shall provide all reasonable protection to prevent damage, injury or loss to:

- .1 all employees on the Work and all other persons who may be affected thereby;
- .2 all the Work and all materials and equipment to be incorporated therein, whether in storage on or off the site, under the care, custody or control of the Contractor or any of his Subcontractors or Sub-subcontractors; and
- .3 other property at the site or adjacent thereto, including trees, shrubs, lawns, walks, pavements, roadways, structures and utilities not designated for removal, relocation or replacement in the course of construction.

10.2.2 The Contractor shall give all notices and comply with all applicable laws, ordinances, rules, regulations and lawful orders of any public authority bearing on the safety of persons or property or their protection from damage, injury or loss.

10.2.3 The Contractor shall erect and maintain, as required by existing conditions and progress of the Work, all reasonable safeguards for safety and protection, including posting danger signs and other warnings against hazards, promulgating safety regulations and notifying owners and users of adjacent utilities.

10.2.4 When the use of storage of explosives or other hazardous materials or equipment is necessary for the execution of the Work, the Contractor shall exercise the utmost care and shall carry on such activities under the supervision of properly qualified personnel.

10.2.5 The Contractor shall promptly remedy all damage or loss (other than damage or loss insured under Paragraph 11.3) to any property referred to in Clauses 10.2.1.2 and 10.2.1.3 caused in whole or in part by the Contractor, and Subcontractor, and Sub-subcontractor, or anyone directly or indirectly employed by any of them, or by anyone for whose acts any of them may be liable and for which the Contractor is responsible under Clauses 10.2.1.2 and 10.2.1.3, except damage or loss attributable to the acts or omissions of the City or Public Works Director or anyone directly or indirectly employed by either of them, or by anyone for whose acts either of them may be liable, and not attributable to the fault or negligence of the Contractor. The foregoing obligations of the Contractor are in addition to his obligations under Paragraph 4.18.

10.2.6 The Contractor shall designate a responsible member of his organization at the site whose duty shall be the prevention of accidents. This person shall be the Contractor's superintendent unless otherwise designated by the Contractor in writing to the City and the Public Works Director.

10.2.7 The Contractor shall not load or permit any part of the Work to be loaded so as to endanger its safety.

10.3 EMERGENCIES

10.3.1 In any emergency affecting the safety of persons or property, the Contractor shall act, at his discretion, to prevent threatened damage, injury or loss. Any additional compensation or extension of time claimed by the Contractor on account of emergency work shall be determined as provided in Article 12 for Changes in the Work.

10.4 OCCUPATIONAL SAFETY AND HEALTH ADMINISTRATION (OSHA)

10.4.1 Safety Training

Contractor shall provide a ten (10) hour Occupational Safety and Health Administration (OSHA) construction safety program for all employees who will be on-site at the project. The construction safety program shall include a course in construction safety and health that is approved by OSHA or a similar program approved by the Missouri Department of Labor and Industrial Relations which is at least as stringent as an approved OSHA program as required by Section 292.675, R.S.Mo.

Contractor shall require its on-site employees to complete a safety program within sixty (60) days after the date work on the project commences.

Contractor acknowledges and agrees that any of Contractor's employees found on the project site without the documentation of the successful completion of a construction safety program shall be required to produce such documentation within twenty (20) days, or will be subject to removal from the project.

Contractor shall require all of its subcontractors to comply with the requirements of this Section and Section 292.675, R.S.Mo.

10.4.2 Notice of Penalties for Failure to Provide Safety Training

Pursuant to Section 292.675, R.S.Mo, Contractor shall forfeit to City as a penalty two thousand five hundred dollars (\$2,500.00), plus one hundred dollars (\$100.00) for each on-site employee employed by Contractor or its Subcontractor, for each calendar day, or portion thereof, such on-site employee is employed without the construction safety training required in Section 10.4.1 above.

The penalty described in above Subsection A of this section shall not begin to accrue until the time periods described in Section 10.4.1 above have elapsed.

Violations of Section 10.4.1 above and imposition of the penalty described in this Section shall be investigated and determined by the Missouri Department of Labor and Industrial Relations.

10.5 MISSOURI REVISED STATUTES

Chapter 319 - General Safety Requirements - Sections 319.075 - 319.090

10.5.1 Citation of law.

319.075. Sections 319.075 to 319.090 may be cited and shall be known as the "Overhead Power Line Safety Act".

(L. 1991 S.B. 214 & 264 § 1)

(2005) Act does not affect or create an exception to an employer's immunity under the Worker's Compensation Act. *Crow v. Kansas City Power and Light Co.*, 174 S.W.3d 523 (Mo.App. W.D.).

10.5.2 Definitions.

319.078. As used in sections 319.075 to 319.090, the following terms mean:

(1) "Authorized person":

(a) An employee of a public utility or an employee of a contractor which has been authorized by a public utility to perform construction, operation or maintenance on or near the poles or structures of such utility;

(b) An employee of a cable television or communication services company or an employee of a contractor authorized to make cable television or communication service attachments; or

(c) An employee of the state or a county or municipality which has authorized circuit construction, operation or maintenance on or near the poles or structures of a public utility;

(2) "High voltage", electric potential in excess of six hundred volts measured between conductors or between a conductor and the ground;

(3) "Overhead lines", all electrical conductors installed above ground;

(4) "Person", an individual, firm, joint venture, partnership, corporation, association, municipality, or governmental unit which performs or contracts to perform any function or activity upon any land, building, highway or other premises in proximity to an overhead line;

(5) "Public utility" includes those entities defined as such in section 386.020, R.S.Mo, as well as municipally owned electrical systems and electric cooperatives provided for in chapters 91 and 394, RSMo.

(L. 1991 S.B. 214 & 264 § 2)

Activities within ten feet of power lines prohibited, exceptions.

319.080. Unless danger against contact with high voltage overhead lines has been guarded against as provided by section 319.083, no person, individually or through an agent or employee, shall store, operate, erect, maintain, move or transport any tools, machinery, equipment, supplies or materials or any other device that conducts electricity, within ten feet of any high voltage overhead line, or perform or require any other person to perform any function or activity upon any land, building, highway or other premises, if at any time during the performance thereof it could reasonably be expected that the person performing the function or activity could move or be placed within ten feet of any high voltage overhead line.

(L. 1991 S.B. 214 & 264 § 3)

10.5.3 Special devices and precautions required--costs.

319.083. 1. When any person desires to temporarily carry out any function or activity in closer proximity to any high voltage overhead line than is permitted by sections 319.075 to 319.090, the person or persons responsible for the function or activity shall notify the public utility which owns or operates the high voltage overhead line of the function or activity, and shall make appropriate arrangements with the public utility for temporary mechanical barriers, temporary de-energization and grounding of the conductors, temporary rerouting of electric current or temporary relocating of the conductors, before proceeding with any function or activity which would impair the clearances required by sections 319.075 to 319.090.

2. A person requesting a public utility to provide temporary clearances or other safety precautions shall be responsible for payment of those costs incurred by such utility in the temporary rerouting of electric current or the temporary relocating of the conductors. Upon request, a public utility shall provide a written cost estimate for the work needed to provide temporary clearances or other safety precautions. A public utility is not required to provide such clearances or other safety precautions until payment of the estimated amount has been made. Unless otherwise agreed to, a public utility shall commence work on such clearances or other safety precautions within seven working days after payment has been made.

(L. 1991 S.B. 214 & 264 § 4)

10.5.4 Presumption of negligence, when, rebuttable.

319.085. If a violation of any of the provisions of sections 319.075 to 319.090 results in physical or electrical contact with any high voltage overhead line such violation shall be a rebuttable presumption of negligence on the part of the

violator in the event such violation shall cause injury, loss or damage, and, notwithstanding any other law to the contrary, the public utility shall have the right of contribution against any such violator. In addition to any penalties provided herein, liability under common law may apply.

(L. 1991 S.B. 214 & 264 § 5)

10.5.5 Exemptions from law.

319.088. Sections 319.075 to 319.090 shall not apply to:

(1) Construction, operation or maintenance of power lines and telecommunications lines or authorized attachments thereto by an authorized person as defined in section 319.078; or

(2) Governmental entities responding to an emergency situation.

(L. 1991 S.B. 214 & 264 § 6)

10.5.6 Violations, penalty.

319.090. Any person who violates any of the provisions of sections 319.075 to 319.088 is guilty of a class B misdemeanor.

(L. 1991 S.B. 214 & 264 § 7)

ARTICLE 11 INSURANCE

11.1 CONTRACTOR'S LIABILITY INSURANCE

11.1.1 The Contractor shall purchase and maintain such insurance as will protect him from claims set forth below which may arise out of or result from the Contractor's operations under the Contract, whether such operations be by himself or by any Subcontractor or by anyone directly or indirectly employed by any of them, or by anyone for whose acts any of them may be liable:

.1 claims under workers' or worker's compensation, disability benefit and other similar employee benefit acts;

.2 claims for damage because of bodily injury, occupational sickness or disease, or death of his employees;

.3 claims for damages because of bodily injury, sickness or disease, or death of any person other than his employees;

.4 claims for damages insured by usual personal injury liability coverage which are sustained (1) by any person as a result of an offense directly or indirectly related to the employment of such person by the Contractor, or (2) by any other person;

.5 claims for damages, other than to the Work itself, because of injury to or destruction of tangible property, including loss of use resulting therefrom; and

.6 claims for damages because of bodily injury or death of any person or property damage arising out of the ownership, maintenance or use of any motor vehicle.

11.1.2 The insurance required by Subparagraph 11.1.1 shall be written for not less than any limits of liability specified in the Contract Documents, or required by law, whichever is greater.

11.1.3 The insurance required by Subparagraph 11.1.1 shall include contractual liability insurance applicable to the Contractor's obligations under Paragraph 4.18.

11.1.4 Certificates of insurance acceptable to the City shall be filed with the City prior to commencement of the Work. These Certificates shall contain a provision that coverage afforded under the policies will not be cancelled until at least thirty days' prior written notice has been given to the Public Works Director.

11.2 CITY'S LIABILITY INSURANCE

11.2.1 The City shall be responsible for purchasing and maintaining his own liability insurance and, at his option, may purchase and maintain such insurance as will protect him against claims which may arise from operations under the Contract.

11.3 CONTRACTOR'S BUILDERS' RISK INSURANCE

11.3.1 The Contractor shall provide Builders' Risk Insurance to a minimum of the coverage or the value of the work.

ARTICLE 12 CHANGES IN THE WORK

12.1 CHANGE ORDERS

12.1.1 A Change Order is a written order to the Contractor signed by the Mayor and the Public Works Director issued after execution of the Contract, authorizing a change in the Work or an adjustment in the Contract Sum or the Contract Time. The Contract Sum and the Contract Time may be changed only by Change Order. A Change Order signed by the Contractor indicates his agreement therewith, including the adjustment in the Contract Sum or the Contract Time.

12.1.2 The City, without invalidating the Contract, may order changes in the Work within the general scope of the Contract consisting of additions, deletions or other revisions, the Contract Sum and the Contract Time being adjusted accordingly. All such changes in the Work shall be authorized by Change Order, and shall be performed under the applicable conditions of the Contract Documents.

The cost or credit to the City resulting from a change in the Work shall be determined in one or more of the following ways:

- .1 by mutual acceptance of a lump sum properly itemized and supported by sufficient substantiating data to permit evaluation;
- .2 by unit prices stated in the Contract Documents or subsequently agreed upon;
- .3 by cost to be determined in a manner agreed upon by the parties and a mutually acceptable fixed or percentage fee; or
- .4 by method provided in Subparagraph 12.1.4.

12.1.2 If none of the methods set forth in Clauses 12.1.3.1, 12.1.2.2, or 12.1.3.3 is agreed upon, the Contractor, provided he receives a written order signed by the Mayor, shall promptly proceed with the Work involved. The cost of such Work shall then be determined by the Public Works Director on the basis of the reasonable expenditures and savings of those performing the Work attributable to the change, including, in the case of an increase in the Contract Sum, a reasonable allowance for overhead and profit. In such case, and also under Clauses 12.1.3.3 and 12.1.3.4 above, the Contractor shall keep and present, in such form as the Public Works Director may prescribe, an itemized accounting together with appropriate supporting data for inclusion in a Change Order. Unless otherwise provided in the Contract Documents, cost shall be limited to the following: cost of materials, including sales tax and cost of delivery; cost of labor, including social security, old age and unemployment insurance, and fringe benefits required by agreement or custom; workers, or worker's compensation insurance; bond premiums; rental value of equipment and machinery; and the additional cost of supervision and field office personnel directly attributable to the change. Pending final determination of cost to the Owner, payments on account shall be made on the Public Works Director's Certificate for Payment. The amount of credit to be allowed by the Contractor to the City of any

deletion or change which results in a net decrease in the Contract Sum will be the amount of the actual net cost as confirmed by the Public Works Director. When both additions and credits covering related Work or substitutions are involved in any one change, the allowance for overhead and profit shall be figured on the basis of the net increase, if any, with respect to that change.

12.1.3 If unit prices are stated in the Contract Documents or subsequently agreed upon, and if the quantities originally contemplated are so changed in a proposed Change Order that application of the agreed unit prices to the quantities of Work proposed will cause substantial inequity to the City or the Contractor, the applicable unit prices shall be equitably adjusted.

12.2 CONCEALED CONDITIONS

12.2.1 Should concealed conditions encountered in the performance of the Work below the surface of the ground or should concealed or unknown conditions in an existing structure be at variance with the conditions indicated by the Contract Documents, or should unknown physical conditions below the surface of the ground or should concealed or unknown conditions in an existing structure of an unusual nature, differing materially from those ordinarily encountered and generally recognized as inherent in work of the charter provided for in this Contract be encountered, the Contract Sum shall be equitably adjusted by Change Order upon claim by either party made within twenty days after the first observance of the conditions.

12.3 CLAIMS FOR ADDITIONAL COST

12.3.1 If the Contractor wishes to make a claim for an increase in the Contract Sum, he shall give the Public Works Director written notice thereof within twenty days after the occurrence of the event giving rise to such claim. This notice shall be given by the Contractor before proceeding to execute the Work, except in an emergency endangering life or property in which case the Contractor shall proceed in accordance with Paragraph 10.3. No such claim shall be valid unless so made. If the City and the Contractor cannot agree on the amount of the adjustment in the Contract Sum, it shall be determined by the Public Works Director. Any change in the Contract Sum resulting from such claim shall be authorized by Change Order.

12.3.2 If the Contractor claims that additional cost is involved because of, but not limited to, (1) any written interpretation pursuant to Subparagraph 2.2.8, (2) any order by the Owner to stop the Work pursuant to Paragraph 3.3 where the Contractor was not at fault, (3) any written order for a minor change in the Work issued pursuant to Paragraph 12.4, or (4) failure of payment by the Owner pursuant to Paragraph 9.7, the Contractor shall make such claim as provided in Subparagraph 12.3.1.

12.4 MINOR CHANGES IN THE WORK

12.4.1 The Public Works Director will have authority to order minor changes in the Work not involving an adjustment in the Contract Sum or an extension of the contract Time and not inconsistent with the intent of the Contract Documents. Such changes shall

be effected by written order, and shall be binding on the City and the Contractor. The Contractor shall carry out such written orders promptly.

ARTICLE 13
UNCOVERING AND CORRECTION OF WORK

13.1 UNCOVERING OF WORK

13.1.1 If any portion of the Work should be covered contrary to the request of the Public Works Director or to requirements specifically expressed in the Contract Documents, it must, if required in writing by the Public Works Director, be uncovered for his observation and shall be replaced at the Contractor's expense.

13.1.2 If any other portion of the Work has been covered which the Public Works Director has not specifically requested to observe prior to being covered, the Public Works Director may request to see such Work and it shall be uncovered by the Contractor. If such Work be found in accordance with the Contract Documents, the cost of uncovering and replacement shall, by appropriate Change Order, be charged to the City. If such Work be found not in accordance with the Contract Documents, the Contractor shall pay such costs unless it be found that this condition was caused by the City or a separate Contractor as provided in Article 6, in which event the City shall be responsible for the payment of such costs.

13.2 CORRECTION OF WORK

13.2.1 The Contractor shall promptly correct all Work rejected by the Public Works Director as defective or as failing to conform to the Contract Documents whether observed before or after Substantial Completion and whether or not fabricated, installed or completed. The Contractor shall bear all costs of correcting such rejected Work, including compensation for the Public Works Director's additional services made necessary thereby.

13.2.2 If, within one year after the Date of Substantial Completion of the Work or designated portion thereof or within one year after acceptance by the City of designated equipment or within such longer period of time as may be prescribed by law or by the terms of any applicable special warranty required by the Contract Documents, any of the Work is found to be defective or not in accordance with the Contract Documents, the Contractor shall correct it promptly after receipt of a written notice from the City to do so unless the City has previously given the Contractor a written acceptance of such condition. This obligation shall survive termination of the Contract. The City shall give such notice promptly after discovery of the condition.

13.2.3 The Contractor shall remove from the site all portions of the Work which are defective or non-conforming and which have not been corrected under subparagraphs 4.5.1, 13.2.1 and 13.2.2, unless removal is waived by the City.

13.2.4 If the Contractor fails to correct defective or nonconforming Work as provided in Subparagraphs 4.5.1, 13.2.1, and 13.2.2, the City may correct it in accordance with Paragraph 3.4.

13.2.5 If the Contractor does not proceed with the correction of such defective or non-conforming Work within a reasonable time fixed by written notice from the Public Works Director, the City may remove it and may store the materials or equipment at the expense of the Contractor. If the Contractor does not pay the cost of such removal and storage within ten days thereafter, the City may upon ten additional days' written notice sell such Work at auction or at private sale and shall account for the net proceeds thereof, after deducting all the costs that should have been borne by the Contractor, including compensation for the Public Works Director's additional services made necessary thereby. If such proceeds of sale do not cover all costs which the Contractor should have borne, the difference shall be charged to the Contractor and an appropriate Change Order shall be issued. If the payments then or thereafter due the Contractor are not sufficient to cover such amount, the Contractor shall pay the difference to the City.

13.2.6 The Contractor shall bear the cost of making good all work of the City or separate Contractors destroyed or damaged by such correction or removal.

13.2.7 Nothing contained in this Paragraph 13.2 shall be construed to establish a period of limitation with respect to any other obligation which the Contractor might have under the Contract Documents, including Paragraph 4.5 hereof. The establishment of the time period of one year after the Date of Substantial Completion or such longer period of time as may be prescribed by law or by the terms of any warranty required by the Contract Documents relates only to the specific obligation of the Contractor to correct the Work, and has no relationship to the time within which his obligation to comply with the Contract Documents may be sought to be enforced, nor to the time within which proceedings may be commenced to establish the Contractor's liability with respect to his obligations other than specifically to correct the Work.

13.3. ACCEPTANCE OF DEFECTIVE OR NON-CONFORMING WORK

13.3.1 If the Public Works Director prefers to accept defective or nonconforming Work, he may do so instead of requiring its removal and correction, in which case a Change Order will be issued to reflect a reduction in the Contract Sum where appropriate and equitable. Such adjustment shall be effected whether or not final payment has been made.

ARTICLE 14
TERMINATION OF THE CONTRACT

14.1 TERMINATION OF THE CONTRACT

14.1.1 If the Work is stopped for a period of thirty days under an order of any court or other public authority having jurisdiction, or as a result of an act of government, such as a declaration of a national emergency making materials unavailable, through no act or fault of the Contractor or a Subcontractor or their agents or employees or any other persons performing any of the Work under a contract with the Contractor, or if the work should be stopped for a period of thirty days by the Contractor because the Public Works Director has not issued a Certificate for Payment as provided in Paragraph 9.7 or because the City has not made payment thereon as provided in Paragraph 9.7, then the Contractor may, upon seven additional days' written notice to the City and the Public Works Director, terminate the Contract and recover from the City payment for all Work executed and for any proven loss sustained upon any materials, equipment, tools, construction equipment and machinery, including reasonable profit and damages.

14.2 TERMINATION BY THE CITY

14.2.1 If the Contractor is adjudged a bankrupt, or if he makes a general assignment for the benefit of his creditors, or if a receiver is appointed on account of his insolvency, or if he persistently or repeatedly refuses or fails, except in cases for which extension of time is provided, to supply enough properly skilled workmen or proper materials, or if he fails to make prompt payment to Subcontractors or for materials or labor, or persistently disregards, laws, ordinances, rules, regulations or orders of any public authority having jurisdiction, or otherwise is guilty of a substantial violation of a provision of the Contract Documents, then the City, upon certification by the Public Works Director that sufficient cause exists to justify such action may without prejudice to any right or remedy and after giving the Contractor and his surety, if any, seven days' written notice, terminate the employment of the Contractor and take possession of the site and of all materials, equipment, tools, construction equipment and machinery thereon owned by the Contractor and may finish the Work by whatever method he may deem expedient. In such case the Contractor shall not be entitled to receive any further payment until the work is finished.

14.2.2 If the unpaid balance of the Contract Sum exceeds the costs of finishing the Work, including compensation for the Public Works Director's additional services made necessary thereby, such excess shall be paid to the Contractor. If such costs exceed the unpaid balance, the Contractor shall pay the difference to the City. The amount to be paid to the Contractor or to the City, as the case may be, shall be certified by the Public Works Director, upon application, in the manner provided in Paragraph 9.4, and this obligation for payment shall survive the termination of the Contract.

ARTICLE 15
SUPPLEMENTAL GENERAL CONDITIONS

15.1 CERTIFICATE OF OWNER’S ATTORNEY

15.1.1 The CERTIFICATE OF OWNER’S ATTORNEY shall be a part of the CONTRACT DOCUMENTS.

15.2 CONFLICT OF INTEREST

15.2.1 No member of or delegate to Congress, or Resident Commissioner, shall be admitted to any share or part of this AGREEMENT or to any benefit that may arise therefrom, but this provision shall not be construed to extend to this AGREEMENT if made with a corporation for its general benefit.

15.2.2 No official of the OWNER who is authorized in such capacity and on behalf of the OWNER to negotiate, make, accept or approve, or to take part in negotiating, making, accepting, or approving any architectural, engineering, inspecting, construction of the project, shall become directly or indirectly interested personally in this AGREEMENT or in any part thereof. No officer, employee, ARCHITECT, ATTORNEY, Public Works Director or INSPECTOR of or for the OWNER who is authorized in such capacity and on behalf of the OWNER who is in any legislative, executive, supervisory, or other similar function in connection with the construction of the project, shall become directly or indirectly interested personally in this AGREEMENT in any part thereof, any material supply contract, subcontract, insurance contract, or any other contract pertaining to the project.

15.3 COPELAND “ANTI-KICK-BACK ACT”

15.3.1 Title 18, U.S.C. 874, Kickbacks from public works employees:

Whoever, by force, intimidation, or threat of procuring dismissal from employment, or by any other manner whatsoever induces any person employed in the construction, prosecution, completion or repair of any public building, public work, or building or work financed in whole or in part by loans or grants from the United States, to give up any part of the compensation to which he is entitled under his contract of employment, shall be fined not more than \$5,000 or imprisoned not more than five years, or both.

15.3.2 Title 40, U.S.C. (as amended) 276c. Regulations governing Contractors and subcontractors:

The Secretary of Labor shall make reasonable regulations for CONTRACTORS and SUBCONTRACTORS engaged in the construction, prosecution, completion or repair of public buildings, public works or building or works financed in whole or in part by loans or grants from the United States, including a provision that each CONTRACTOR and SUBCONTRACTOR shall furnish weekly a statement with respect to the wages paid

each employee during the preceding week. Section 1001 of Title 18 of the United States Code (Criminal Code and Criminal procedure) shall apply to such statements.

The OWNER shall report all suspected or reported violations to the Department of Natural Resources.

15.4 CLEAN AIR ACT

15.4.1 If the contract exceeds \$100,000, the CONTRACTOR agrees to comply with all the requirements of Section 114 of the Clean Air Act and (42 U.S.C. 1857 C-9) Section 308 of the Water Pollution Control Act (33 U.S.C. 1318) relating to inspection, monitoring, entry, reports, and information, as well as all other requirements specified in Section 114 of the Clean Air Act and Section 308 of the Water Pollution Control Act and all regulations and guidelines issued thereunder after the award of the contract. Such regulations and guidelines can be found at 40 C.F.R. 15.4 and 40 FR 17126 dated April 16, 1975. In so doing the CONTRACTOR further agrees:

15.4.2 As a condition for the award of contract, to notify the OWNER of the receipt of any communication from the Environmental Protection Agency (EPA) indicating that a facility to be utilized in the performance of the contract is under consideration to be listed on the EPA list of Violating Facilities. Prompt notification is required prior to contract award.

15.4.3 To certify that any facility to be utilized in the performance of any nonexempt Contractor subcontract is not listed on the EPA list of Violating Facilities pursuant to 40 C.F.R. 15.20 as of the date of contract award.

15.4.4 To include or cause to be included the above criteria and requirements in every nonexempt subcontract and that the CONTRACTOR will take such action as the Government may direct as a means of enforcing such provisions.

15.4.5 As used in these paragraphs the term “facility” means any building, plant, installation, structure, mine, vessel or other floating craft, location, or site of operations, owned, leased or supervised by a grantee, cooperator, CONTRACTOR, or SUBCONTRACTOR, to be utilized in the performance of a grant, agreement, contract, subgrant, or subcontract. Where a location or site of operations contains or includes more than one building, plant, installation, or structure, the entire location shall be deemed to be a facility except where the Director, Office of Federal Activities, Environmental Protection Agency, determines that independent facilities are collocated in one geographic area.

SPECIAL CONDITIONS

1.1 INSURANCE

Contractor shall provide and maintain during the life of the Contract and until final acceptance of the work, insurance acceptable to the City which will afford protection and coverage in accordance with the requirements set forth below.

1.2 WORKERS' COMPENSATION INSURANCE

Workers' Compensation Insurance for all employees at the site of the project, and in case any work is sublet, Contractor shall require any Subcontractor similarly to provide Workers' Compensation Insurance for all the latter's employees unless such employees are covered by the protection afforded by Contractor. In case any class of employees engaged in hazardous work under this contract at the site of the project is not covered under the Workers' Compensation Statute, the Contractor shall provide and shall cause each Subcontractor to provide Employer's Liability Insurance. Contractor shall provide coverage under the "Occupational Disease Act" of the State of Missouri, in addition to the above requirements if the operations of the Contractor or any Subcontractor are applicable thereunder, Workers' Compensation Insurance shall comply in all respects with the requirements of the statutes of the State of Missouri.

1.3 PUBLIC LIABILITY AND PROPERTY DAMAGE INSURANCE

Public Liability and Property Damage Insurance in comprehensive general liability form as well shall protect Contractor and any Subcontractor performing work covered by this contract from claims for damages for personal injury, including wrongful death, and claims for property damage which may arise from the operations under the contract, including all trucks and automobiles used, whether owned or not, and whether such operations be by the contractor or any Subcontractor or by anyone directly or indirectly employed by either of them. The amount of insurance shall not be less than the following with the City to be named as Additional Named Insured with endorsement coverage.

- 1) Public Liability Insurance: The Contractor shall carry commercial general liability insurance and commercial automobile liability insurance from a company authorized to issue insurance in Missouri, and to name the City as additional named insured with endorsement coverage in amounts sufficient to cover the sovereign immunity limits for Missouri public entities (\$3,000,000 per claimant and \$3,000,000 per occurrence) as calculated by the Missouri Department of Insurance, Financial Institutions and Professional Registration, and published annually in the Missouri Register pursuant to Section 537.610 R.S.Mo.
- 2) Property Damage Insurance shall be in the combined single limit of not less than \$3,000,000.00, however, that insurance on all automobiles and trucks

shall be for bodily injury in the prescribed limits of not less than \$3,000,000.00. Such policy or policies shall be proper endorsement cover any liability of Contractor under the indemnification provision, Paragraph 4.18 of the General Conditions.

- 3) Insurance Covering Special Hazards – The Public Liability and Property Damage Insurance Policy or policies of the Contractor shall provide coverage such as operation of material hoists, blasting or other use of explosives, and damage to underground property.
- 1.3.1 All insurance shall be procured through agencies and be written by insurance companies which are acceptable to and approved by Owner and shall be obtained and paid for by Contractor.
- 1.3.2 Within fourteen (14) days after award of the Contract, Contractor shall furnish the City with certificates that the City is covered by the required insurance, showing type, amount, class of operations covered, effective dates and dates of expiration of policies. All certificates shall contain substantially the statement: “The insurance covered by this certificate will not be cancelled or altered except after thirty (30) days’ written notice has been received by the City of Rolla, Missouri”. In addition, the original City’s protective policy will be forwarded to the City.
- 1.3.3 Upon receipt of any notice of cancellation or alteration, Contractor shall within five (5) days procure other policies of insurance similar in all respects to the policy or policies about to be cancelled or altered; and if Contractor fails to provide, procure and deliver acceptable policies of insurance or satisfactory certificates or other evidence thereof, Owner may obtain such insurance at the cost and expense of Contractor without notice to Contractor.
- 1.3.4 The Contractor shall provide Builders’ Risk Insurance to a minimum of the coverage of the value of the work.
- 1.3.5 It is understood and agreed that the insurance required by the provisions of this article is required in the public interest and that the City does not assume any liability for acts of Contractor, any Subcontractor, or their employees, in the performance of the Contract.

2. TIME FOR COMPLETION

The completion date will be **May 1, 2027**.

3. LIQUIDATED DAMAGES

- 3.1 Liquidated Damages - Should the contractor fail to complete the work on or before the completion date specified the contractor will be charged liquidated damages in the amount of **500.00** per calendar day for each full calendar day that the work is not fully completed. Liquidated damages will not be charged for weekends and holidays.

- 3.2 Liquidated Damages will be waived for any period of time covered by an extension of time as provided in Paragraph 8.3 of the General Conditions and under other provisions of the Contract Documents.
- 3.3 The Owner shall have the right to deduct Liquidated Damages from any payments due or to become due the Contractor or to recover compensation for damages for nonperformance as provided for under other provisions of the Contract Documents.

4. SPECIAL WAGE DETERMINATION

The Contractor shall comply with the special wage determination pertaining to minimum wage rates to be paid workers employed on this project as determined by the Department of Labor and Industrial Relations, State of Missouri. See the enclosed State of Missouri Special Wage Determination.

5. NONDISCRIMINATION IN EMPLOYMENT

In connection with the performance of work under this Contract, the Contractor agrees as follows:

- 5.1 Contractor will not discriminate against any employee or application for employment because of race, creed, color, national origin or sex or marital status. The Contractor will take affirmative action to insure that applicants are employed and that employees are treated during employment without regard to their race, creed, color, or national origin or sex or marital status. Such action shall include, but not be limited to, the following: employment, upgrading, demotion or transfer; recruitment advertising; layoff or termination; rates of pay or other forms of compensation; and selection for training, including apprenticeship.
- 5.2 Contractor will, in all solicitations or advertisements for employees placed by or on behalf of the Contractor, state that all qualified applicants will receive consideration for employment without regard to race, creed, color or national origin or sex or marital status.
- 5.3 In the event of the Contractor's noncompliance with nondiscrimination clause of this Contract, the Owner may cancel this Contract in whole or in part.

6. PAYMENTS

- 6.1 Payments will be made to Contractor monthly from lawful funds available therefore on the basis of a duly certified estimate of all labor and materials done or delivered on the site of construction and accepted by the City's representative during the preceding month, calculated in proportion to the Contract price.
- 6.2 Not later than the first day of each calendar month, Contractor shall render two copies of all statements for progress payments to Owner by mailing or delivering

same to the Public Works Director. All statements shall be subject to approval of the City's representative and the governing body of the City of Rolla.

- 6.3 To insure proper performance of the Contract, Owner will retain ten percent (10%) of the amount of each estimate until final completion and acceptance of the work covered by the Contract.
- 6.4 Each payment made to Contractor shall be on account of the total amount payable to Contractor by or for Owner, and all material and work covered by partial payment made shall thereupon become the sole property of Owner. No such payment shall be deemed to be in accord and satisfaction as to any item or items for which such payment is made, and this provision shall not be construed as relieving Contractor from sole responsibility for care and protection of materials and work upon which payments have been made or restoration of any damaged work or as a waiver of the right of Owner to require fulfillment of all terms of the Contract.
- 6.5 Ordinarily no allowance will be made in estimates for materials delivered on site of work and not incorporated into work; however, items considered by Owner to be major items of considerable magnitude, if suitably stored, will be allowed in estimates on the basis of ninety percent (90%) of invoices, the value calculated in proportion to the contract price.
- 6.6 Retained percentages herein provided are to be retained and held for the sole protection and benefit of Owner, and no other person, firm or corporation shall have or assert any lien, claim or right whatsoever thereto, except as herein expressly provided.
- 6.7 The Contractor shall be responsible for supplying the City with weekly payroll sheets, Form No. 44-R1093.
- 6.8 All requests for payment shall be made to the City on forms approved by the Public Works Director.
- 6.9 The Contractor will be supplied with a tax exemption certificate for all materials purchased for the project.

7. LOCATION AND GRADE

The alignment and grade will be shown on the plans or as directed by the Public Works Director. All necessary lines and grades will be given by the Public Works Director. All staking shall be completed by Public Works project coordinators. All work completed by other shall be graded plus or minus two tenths of a foot (.2±').

8. BARRICADES

- 8.1 Contractor shall be responsible for all barricades and warning devices to warn and alert drivers of hazards created by construction activities in or near the traveled way and to guide and direct drivers safely past the hazards.
- 8.2 Barricades shall conform to the pertinent sections of the current edition of the Manual on Uniform Traffic Control Devices, published by the Federal Highway Administration.
- 8.3 Barricade warning lights shall be required when hazards are left unattended overnight and shall conform to the pertinent sections of the current edition of the Manual of Uniform Traffic control devices, type A, published by the Federal Highway Administration. Open flame lanterns or torches will not be allowed.
- 8.4 Barricades and warning lights shall be placed as to adequately warn motorists of hazards as well as to protect workers or as directed by the Public Works Director.
- 8.5 Cost of barricades shall be included in the Lump Sum price for Traffic Control and no additional compensation shall be allowed.
- 8.6 Street lane restrictions and/or closings shall be coordinated with the City of Rolla Street Department.
- 8.7 Contractor shall be responsible for but not limited to providing all traffic control signage, lights, cones, barricades, flag persons, and/or any device needed for safe traffic control on federal, state, county, and city right-of-ways.
- 8.8 All excavation must be closed at the end of each day or must be fenced to prevent injury to persons and/or property.
- 8.9 Traffic control and safety shall be strictly enforced. Demobilization and remobilization fees associated with traffic control and safety shall not be reimbursed under any circumstances.
- 8.10 Contractor shall be responsible for barricading all water valves and manholes to prevent personal injury or property damage by others.

9. HOLD HARMLESS AGREEMENT

The following hold harmless agreement shall be executed and submitted within fourteen (14) days of award of bid.

10. AFFIDAVIT COMPLIANCE WITH THE PREVAILING WAGE LAW

Before the final payment can be made to the Contractor on the project, the Contractor must complete and return the Affidavit Compliance with the Prevailing Wage Law form furnished at the end of the Special Conditions section.

11. CONTRACTOR'S AFFIDAVIT REGARDING SETTLEMENT OF CLAIMS

Before the final payment can be made on the project to the Contractor, the Contractor must complete and return the Contractor's Affidavit Regarding Settlement of Claims form furnished at the end of the Special Conditions Section.

HOLD HARMLESS AGREEMENT FORM

We, _____ agree to protect, indemnify, save and keep harmless the City of Rolla against and from any and all loss, cost, damage or expense, arising out of or from any accident or other occurrence on or about said premises, causing injury to any person or property whomsoever and whatsoever and will protect, indemnify and save and keep harmless the above mentioned party from any and all claims, costs or expense arising out of any failure of the Contractor in any respect to comply with and perform all the requirements and provisions agreed to and required by any law or ordinance, during the period commencing _____ at the premise of

_____ .

By

Printed Name of Person Signing

Title

Date

AFFIDAVIT
COMPLIANCE WITH THE PREVAILING LAW

Before me, the undersigned Notary Public, in and for the county of _____,
State of _____, personally came and appeared
_____ of _____
(Name and Title) (Company Name)

(a Corporation) (a Partnership) (a Proprietorship), and after being duly sworn did depose
and say all provisions and requirement set out in Chapter 290, Sections 290.210 through
and including 290.340, Missouri Revised Statutes, pertaining to the payment of wages to
workers employed on public works projects have been fully satisfied and there has been
no exception to the full and complete compliance with said provisions and requirements
and with Wage Determination No. _____ or Annual Wage Order No. _____ issued
by the Division of Labor Standards on Project _____,

(Job No.)
_____, _____ County, Missouri, and
(Route or Location, if building construction)

completed on the _____ day of _____, _____.

Subscribed and sworn to me this _____ day of _____, _____.

My commission expires _____, _____.

(SEAL)

(Notary Public)

**CONTRACTOR'S AFFIDAVIT
REGARDING
SETTLEMENT OF CLAIMS**

_____, 20 _____

To the City of Rolla, Missouri

Gentlemen:

This is to certify that all lawful claims for material, lubricants, fuel, coal, coke, repairs on machinery, groceries and foodstuffs, equipment and tools consumed or used in connection with the construction of the above mentioned project, and all insurance premiums, both compensation and all other kinds of insurance on said work, and for all labor performed in said work, whether by subcontractor or claimant in person or by his employee, agent, servant, bailee or bailor, have been paid and discharged.

Contractor

By _____
(Signature)

(Title)

State of _____

County of _____ ss.

Subscribed and sworn to before me this _____ day of
_____, 20 _____, at _____

Notary Public

SEAL

My Commission expires _____, 20 _____.

WAGE RATES

A legible list of all prevailing wage rates **must remain** posted in a prominent and easily accessible place at the worksite by each contractor and subcontractor on the project. It is a requirement the notice is posted during the full time that any worker is employed on the job as per RsMO 290.265 below.

Wage rates posted, where.

290.265. A clearly legible statement of all prevailing hourly wage rates to be paid to all workmen employed in order to execute the contract and employed on the construction of the public works shall be kept posted in a prominent and easily accessible place at the site thereof by each contractor and subcontractor engaged in the public works projects under the provisions of this law and such notice shall remain posted during the full time that any such workman shall be employed on the public works.

(L. 1969 S.B. 142)

The Contractor will forfeit a penalty to the City of Rolla of \$100 per day (or portion of a day) for each worker who is paid less than the prevailing rate for any work done under the contract by the Contractor or by any Sub-contractor (see Section 290.250, RSMo, enclosed in the Laws Section.) For detailed information on rules and occupational titles, see 8 CSR 30-3.010 through 3.060 (enclosed in the Laws Section, Code of State Regulations – Prevailing Wage Rules.)

Missouri

Division of Labor Standards

WAGE AND HOUR SECTION



MIKE KEHOE, Governor

Annual Wage Order No. 33

Section 081
PHELPS COUNTY

In accordance with Section 290.262 RSMo 2000, within thirty (30) days after a certified copy of this Annual Wage Order has been filed with the Secretary of State as indicated below, any person who may be affected by this Annual Wage Order may object by filing an objection in triplicate with the Labor and Industrial Relations Commission, P.O. Box 599, Jefferson City, MO 65102-0599. Such objections must set forth in writing the specific grounds of objection. Each objection shall certify that a copy has been furnished to the Division of Labor Standards, P.O. Box 449, Jefferson City, MO 65102-0449 pursuant to 8 CSR 20-5.010(1). A certified copy of the Annual Wage Order has been filed with the Secretary of State of Missouri.

Original Signed by _____

Logan Hobbs, Director
Division of Labor Standards

Filed With Secretary of State: _____ **March 10, 2026**

Last Date Objections May Be Filed: **April 9, 2026**

Prepared by Missouri Department of Labor and Industrial Relations

Building Construction Rates For
PHELPS COUNTY

Section 081

OCCUPATIONAL TITLE	**Prevailing Hourly Rate
Asbestos Worker	\$62.81
Boilermaker	\$30.36*
Bricklayer - Stone Mason	\$56.39
Carpenter	\$67.92
Lather	
Linoleum Layers & Cutter	
Millwright	
Pile Driver	
Cement Mason	\$62.64
Plasterer	
Communication Technician	\$67.08
Electrician (Inside Wireman)	\$66.96
Electrician (Outside Lineman)	\$30.36*
Outside - Groundman	
Outside - Groundman Tree Trimmer	
Outside - Lineman Operator	
Outside - Lineman Tree Trimmer	
Elevator Constructor	\$30.36*
Glazier	\$30.36*
Iron Worker	\$75.43
Laborer	\$49.61
Laborer - First Semi-Skilled	
Laborer - General	
Laborer - Second Semi-Skilled	
Laborer - Skilled	
Mason	\$56.11
Marble Finisher	
Marble Mason	
Terrazzo Finisher	
Terrazzo Worker	
Tile Finisher	
Tile Setter	
Operating Engineer	\$71.59
Operating Engineer - Group I	
Operating Engineer - Group II	
Operating Engineer - Group III	
Operating Engineer - Group III - A	
Operating Engineer - Group IV	
Operating Engineer - Group V	
Painter	\$52.21
Plumber	\$75.74
Pipe Fitter	
Roofer/WaterProofer	\$59.22
Sheet Metal Worker	\$80.82
Sprinkler Fitter - Fire Protection	\$71.68
Truck Driver	\$30.36*
Truck Control Service Driver	
Truck Driver, Teamsters Group I	
Truck Driver, Teamsters Group II	
Truck Driver, Teamsters Group III	
Truck Driver, Teamsters Group IV	

* The Division of Labor Standards received fewer than 1,000 reportable hours for this occupational title. The public works contracting minimum wage is established for this occupational title using data provided by Missouri Economic Research and Information Center.
 **The Prevailing Hourly Rate includes any applicable fringe benefit amounts for each occupational title as defined in RSMo Section 290.210.

PHELPS COUNTY

OCCUPATIONAL TITLE	**Prevailing Hourly Rate
Carpenter	\$66.44
Millwright	
Pile Driver	
Electrician (Outside Lineman)	\$30.36*
Outside - Groundman	
Outside - Groundman Tree Trimmer	
Outside - Lineman Operator	
Outside - Lineman Tree Trimmer	
Laborer	\$55.47
Laborer - General	
Laborer - Skilled	
Operating Engineer	\$72.86
Operating Engineer - Group I	
Operating Engineer - Group II	
Operating Engineer - Group III	
Operating Engineer - Group IV	
Truck Driver	\$30.36*
Truck Control Service Driver	
Truck Driver, Teamsters Group I	
Truck Driver, Teamsters Group II	
Truck Driver, Teamsters Group III	
Truck Driver, Teamsters Group IV	

Use Heavy Construction Rates on Highway and Heavy construction in accordance iwth the classifications of construction work established in 8 CSR 30-3.040(3).

Use Building Construction Rates on Building construction in accordance with the classifications of construction work established in 8 CSR 30-3.040(2).

If a worker is performing work on a heavy construction project within an occupational title that is not listed on the Heavy Construction Rate Sheet, use the rate for that occupational title shown on the Building Construction Rate Sheet.

*The Division of Labor Standards received fewer than 1,000 reportable hours for this occupational title. Public works contracting minimum wage is established for this occupational title using data provided by Missouri Economic Research and Information Center.

**The Prevailing Hourly Rate includes any applicable fringe benefit amounts for each occupational title.

OVERTIME and HOLIDAYS

OVERTIME

For all work performed on a Sunday or a holiday, not less than twice (2x) the prevailing hourly rate of wages for work of a similar character in the locality in which the work is performed or the public works contracting minimum wage, whichever is applicable, shall be paid to all workers employed by or on behalf of any public body engaged in the construction of public works, exclusive of maintenance work.

For all overtime work performed, not less than one and one-half (1½) the prevailing hourly rate of wages for work of a similar character in the locality in which the work is performed or the public works contracting minimum wage, whichever is applicable, shall be paid to all workers employed by or on behalf of any public body engaged in the construction of public works, exclusive of maintenance work or contractual obligation. For purposes of this subdivision, "overtime work" shall include work that exceeds ten hours in one day and work in excess of forty hours in one calendar week; and

A thirty-minute lunch period on each calendar day shall be allowed for each worker on a public works project, provided that such time shall not be considered as time worked.

HOLIDAYS

January first;
The last Monday in May;
July fourth;
The first Monday in September;
November eleventh;
The fourth Thursday in November; and
December twenty-fifth;

If any holiday falls on a Sunday, the following Monday shall be considered a holiday.

JOB SPECIAL PROVISIONS TABLE OF CONTENTS

(Job Special Provisions shall prevail over General Special Provisions whenever in conflict therewith).

A. PROJECT CONTACT FOR CONTRACTOR/BIDDER QUESTIONS.....100

B. BUSINESS LICENSE REQUIRMENT100

C. WORK ZONE TRAFFIC MANAGEMENT PLAN100

D. VALVE BOX ADJUSTMENT101

E. WATERLINE PIPES UNDER ROADWAY, OPEN CUT.....101

F. STORM SEWER AND INLET ABANDONMENT AND REMOVAL103

G. CAST IRON TRUCATED DOMES103

H. 2’-0” CURB AND GUTTER.....104

I. TEMPORARY TRAFFIC CONTROL104

J. REINFORCED CONCRETE PIPE105

K. REINFORCED CONCRETE BOX CULVERTS105

L. MANHOLE RIM ADJUSTMENT106

M. SANITARY SEWER MAIN INSTALLATION106

N. INLETS.....107

O. EROSION CONTROL108

P. ACCESS TO COMMERCIAL AND PRIVATE PROPERTIES108

Q. EXISTING UTILITY COORDINATION.....109

R. PROJECT SIGN 110

ADDITIONAL INFORMATION

Existing Pavement Core Samples

Project Sign Specification

A. PROJECT CONTACT FOR QUESTIONS & COORDINATION

- 1.0 Description. All Questions concerning the project shall be forwarded to the project contact listed below:

Matthew Kreyling, P.E.
City of Rolla Public Works Department
P.O. Box 979, 901 N. Elm St.
Rolla, MO 65402
573-364-8659
mkreyling@rollacity.gov

- 2.0 Work requirements.
- 2.1 All questions prior to the bid must be submitted no less than 4 working days prior to the published bid opening.
- 2.2 Preconstruction meeting. Before Contractor starts the Work at the site, a conference attended by Contractor, City staff & others as appropriate must be held to discuss schedules, shop drawings & submittals, and establish a working understanding among the parties as to the work.
- 2.3 Project Schedule. Within 10 working days of the date work commences, Contractor shall submit a project schedule for review and acceptance.
- 2.4 Progress meetings. Contractor shall hold a weekly conference with City staff & others as appropriate to provide progress reports & coordinate work impact on traffic, community events & neighboring properties. Some of these meetings will be open to the public and adjacent property owners and/or residents.

B. BUSINESS LICENSE REQUIREMENT

- 1.0 Description. The successful bidder and all subcontractors will be required to obtain a City of Rolla Business License. The successful bidder must self-perform a minimum of 30% of the work. There will be no direct payment for complying with this provision.

C. WORK ZONE TRAFFIC MANAGEMENT PLAN

- 1.0 Description. Work zone traffic management shall be in accordance with applicable portions of the Manual on Uniform Traffic Control Devices, 11th Edition.
- 2.0 Traffic Management Schedule.
- 2.1 Temporary traffic closures. At no point shall more than one block of Rolla Street and one adjacent cross street be closed at a given time.
- 2.2 Traffic management schedules shall be submitted to the engineer for review prior to the start of work and prior to any revisions to the traffic management schedule.

- The traffic management schedule shall include the proposed traffic control measures, hours traffic control will be in place, and work hours.
- 2.3 The contractor shall notify the engineer one week prior to lane closures, shifting traffic, or reopening the roadway to traffic.
 - 2.4 The engineer shall be notified as soon as practical of any postponement due to weather, material or other circumstances.
 - 2.5 In order to ensure minimal traffic interference, the contractor shall schedule lane closures for the absolute minimum amount of time required to complete the work. Lanes shall not be closed until material is available for continuous construction and the contractor is prepared to diligently pursue the work until the closed lane is opened to traffic.
- 3.0 Basis of Payment. No direct payment will be made to the contractor to recover the cost of equipment, labor, materials or time required to fulfill the above provisions, unless specified elsewhere in the contract document. All changes in the traffic control plan shall be provided in writing for review and approval no less than 2 weeks prior to implementation.

D. VALVE BOX ADJUSTMENT

- 1.0 Description. Waterline Valve Boxes shall be adjusted as needed to match final grade elevations. There are an estimated 30 valve boxes requiring adjustment in these improvements.
- 2.0 Work requirements. Work shall be in accordance with Project Plan and Details for all dimensions, pipe class, materials, and bedding types and sizes. All other aspects of the construction shall comply with Rolla Municipal Utilities Standard Specifications.
- 3.0 Method of Measurement. This work will not be measured for payment but will be considered a lump sum unit.
- 4.0 Basis of Payment. No direct payment will be made to the contractor to recover the cost of equipment, labor, materials or time required to fulfill the above provisions, unless specified elsewhere in the contract document.

E. WATERLINE PIPES UNDER ROADWAY, OPEN CUT

- 1.0 Description. Waterline pipe under roadways shall be of open cut construction at locations and elevations shown on the plans.
- 2.0 Work requirements. Work shall be in accordance with Project Plan and Details for all dimensions, pipe class, materials, and bedding types and sizes. All other aspects of the construction shall comply with Rolla Municipal Utilities Standard

Specifications. Water pipe shall be encased in 18 inch steel carrier pipe with a thickness of at least 0.25 inches.

- 3.0 Method of Measurement. This work will not be measured for payment but will be considered a lump sum unit.
- 4.0 Basis of Payment. Payment for this work shall include all materials, labor, equipment and time necessary to construct the waterline pipe and shall include all pipe; casing; fittings; restraints; restrained vertical bends; anchors; caps; thrust blocks; hydrostatic pressure testing; flushing; disinfecting; separation and protection from other utilities; connections to new and existing pipes, valves and fittings; excavation of all material regardless of character; trenching; bedding; backfill; sawcutting existing pavement and curb; restoring the surface to existing pavement elevation if under proposed pavement, to match existing pavement and curb conditions if under existing pavement and curb, or to final grade with seed or sodding as specified if outside pavement areas; and all incidental work required for a complete installation. No separate payment shall be made for mechanical or restrained joint pipe as needed, rock excavation and removal, shoring, dewatering or any other work incidental to excavation, trenching and backfilling associated with the installation, nor for finish grading, seeding, sodding, pavement or curb restoration, etc necessary for site restoration outside of proposed pavement areas. The accepted quantity will be paid at the contract unit price for Item 14. 12 inch water main relocation.

F. STORM SEWER AND INLET ABANDONMENT AND REMOVAL

- 1.0 Description. Existing Storm Sewers and Inlets shall be capped, plugged, abandoned and/or removed as shown on the plans.
- 2.0 Work requirements. Work shall be in accordance with Project Plan and Details for all dimensions, materials, and sizes. All other aspects of the construction shall comply with the City of Rolla Standard Specifications
- 3.0 Method of Measurement. This work will not be measured for payment but will be considered a lump sum unit.
- 4.0 Basis of Payment. Payment for this work shall include all materials, labor, equipment and time necessary to cap, plug abandon and/or remove and dispose of existing storm sewer pipes and inlets and perform site restoration. The work shall include grout; caps; plugs; excavation of all material regardless of character; trenching; backfill; saw-cutting existing pavement and curb; restoring the surface to existing pavement elevation if under proposed pavement, to match existing pavement and curb conditions if under existing pavement and curb, or to final grade with seed or sodding as specified if outside pavement areas; and all incidental work required for a complete installation. No separate payment shall be made for rock excavation and removal, shoring, dewatering or any other work incidental to excavation, trenching and backfilling associated with the installation, nor for finish grading, seeding, sodding, pavement or curb restoration, etc. necessary for site restoration outside of proposed pavement areas. The accepted quantity will be paid at the contract lump sum price for Item 36. Storm Sewer Abandonment.

G. CAST IRON TRUCATED DOMES

- 1.0 Description. Cast Iron Truncated Domes shall be constructed at the locations shown on the plans.
- 2.0 Work requirements. Work shall be in accordance with Sec 608 of the Standard Specifications and Standard Plan 608.50. The truncated domes shall be made from Cast Iron and wet set integral with the concrete, surface applied products will not be allowed.
- 3.0 Method of Measurement. This work will be measured by the quantity of cast iron truncated domes placed to the nearest square foot.
- 4.0 Basis of Payment. Payment for this work shall include all materials, labor, equipment and time necessary to construct the Cast Iron Truncated Domes as shown in the contract documents. The accepted quantity will be paid for at the contract unit price for Item 31. Cast Iron Truncated Domes, per square foot.

H. 2'-0" CURB AND GUTTER

- 1.0 Description. 2'-0" Curb and Gutter shall be constructed at locations shown on the plans.
- 2.0 Work requirements. Work shall be in accordance with City Standard Drawings 200 and 202 for the dimensions of the curb and gutter only, all other aspects of the construction shall comply with Sec 609 of the Standard Specifications.
- 3.0 Method of Measurement. This work will be measured by the quantity of linear feet placed of concrete curb and gutter and include both rollover curb as well as the standard curb.
- 4.0 Basis of Payment. Payment for this work shall include all materials, labor, equipment and time necessary to construct the 2'-0" Curb and Gutter as shown in the contract documents. The accepted quantity will be paid for at the contract unit price for Item 25. 2 ft Curb and Gutter, per linear foot.

I. TEMPORARY TRAFFIC CONTROL

- 1.0 Description. All work necessary to maintain safe and efficient traffic flow through the work areas shall be provided by the contractor. This will include furnishing, relocating, and removing temporary traffic control devices, and the removal and relocation or covering and uncovering of existing signs and other traffic control devices, placement of temporary pavement marking, removal of existing pavement marking and temporary pavement marking once stage is complete and in accordance with the contract documents or as directed by the engineer. This shall also include any pavement edge treatment, as required.
- 2.0 Work requirements. Work shall be in accordance with the Work Zone Traffic Management Plan as approved and the contract plans.
- 3.0 Method of Measurement. This work will not be measured for payment but will be considered a lump sum unit.
- 4.0 Basis of Payment.
 - 4.1 Partial payments will be made as follows:
 - (a) The first partial payment will be made when five percent of the original contract amount is earned. This payment will be the lesser of 50 percent of the contract price for the item of temporary traffic control or 5 percent of the original contract price.

- (b) The second partial payment will be made when 50 percent of the original contract amount is earned. This payment will be the lesser of 25 percent of the original contract price for the item of temporary traffic control or 2.5 percent of the original contract price.
 - (c) The third partial payment will be made when 75 percent of the original contract amount is earned. This payment will be the lesser of 20 percent of the original contract price for the item of temporary traffic control or 2 percent of the original contract price.
 - (d) When the engineer has accepted the contract for maintenance in accordance with Sec 105, the remaining contract price for the item of temporary traffic control will be paid.
 - (e) The above partial payment schedule may be adjusted by the engineer if proof of invoices submitted by the contractor demonstrate additional temporary traffic control costs were incurred earlier than the above proposed schedule. The total payment for temporary traffic control will not exceed the bid amount for Item 32. Temporary Traffic Control, lump sum.
- 4.1.1 For the purposes of this provision, the term “original contract price” will be construed as the total dollar value of the construction items (excluding temporary traffic control) of the original contract.
- 4.2 Temporary traffic control will be paid for at the contract lump sum price for Item 616-99.01, Temporary Traffic Control. No direct payment will be made for the following:
- (a) Incidental items necessary to complete the work, unless specifically provided as a pay item in the contract.
 - (b) Installing, operating, maintaining, cleaning, repairing, removing or replacing traffic control devices.
 - (c) Covering and uncovering existing signs and other traffic control devices.
 - (d) Relocating temporary traffic control devices, including permanent traffic control devices temporarily relocated, unless specifically included as a pay item in the contract.
 - (e) Providing channelizers.
 - (f) Temporary Surfacing: All excavations in travelways (including driveways shall be temporary surfaced with a minimum of 4” of compacted asphalt or 6” PCCP before returning to traffic. The contractor shall maintain the temporary surfacing to the satisfaction of the engineer until the final surface is installed.

J. REINFORCED CONCRETE PIPE

- 1.0 Description. Reinforced Concrete Pipe shall be constructed at locations and elevations shown on the plans.
- 2.0 Work requirements. Work shall be in accordance with Project Plan and Details for all dimensions, pipe class, materials, and bedding types and sizes. All other

aspects of the construction shall comply with City of Rolla Standard Detail Drawings.

- 3.0 Method of Measurement. This work will be measured by the quantity of linear feet placed of reinforced concrete pipe measured along the longitudinal axis of the pipe from flowline in to flowline out along each pipe alignment.
- 4.0 Basis of Payment. Payment for this work shall include all materials, labor, equipment and time necessary to construct the reinforced concrete pipe and shall include piping; testing; excavation of all material regardless of character; trenching; bedding; backfill; sawcutting existing pavement and curb; connections to new and existing pipes and structures; restoring the surface to existing pavement elevation for proposed pavement; and all incidental work required for a complete installation. No separate payment shall be made for rock excavation and removal, shoring, dewatering or any other work incidental to excavation, trenching and backfilling associated with the installation, nor for finish grading, seeding, sodding, pavement, curb and ground restoration, etc necessary to tie-into and match existing surfaces to remain in place. The accepted quantity will be paid at the contract unit price for Items 6. through 12. for the corresponding pipe sizes, per lineal foot.

K. REINFORCED CONCRETE BOX CULVERTS

- 1.0 Description. Reinforced Concrete Box Culverts shall be constructed at locations and elevations shown on the plans.
- 2.0 Work requirements. Work shall be in accordance with Project Plan and Details for all dimensions, materials, and bedding types and sizes. All other aspects of the construction shall comply with City Standard Detail Drawings and Specifications.
- 3.0 Method of Measurement. This work will be measured by the quantity of linear feet placed of reinforced concrete box culvert measured along the longitudinal axis of the box culvert from flowline in to flowline out along each box culvert alignment.
- 4.0 Basis of Payment. Payment for this work shall include all materials, labor, equipment and time necessary to construct the reinforced concrete box culvert and shall include box culvert; testing; excavation of all material regardless of character; trenching; bedding; backfill; sawcutting existing pavement and curb; connections to new and existing pipes and structures; restoring the surface to existing pavement elevation for proposed pavement; and all incidental work required for a complete installation. No separate payment shall be made for rock excavation and removal, shoring, dewatering or any other work incidental to excavation, trenching and backfilling associated with the installation, nor for finish grading, seeding, sodding, pavement, curb and ground restoration etc

necessary to tie-into and match existing surfaces to remain in place. The accepted quantity will be paid at the contract unit price for Items 2.-5. For the corresponding box sizes, per lineal foot.

L. MANHOLE RIM ADJUSTMENT

- 1.0 Description. Manhole Rims shall be adjusted by City staff as needed to match final grade elevations.

M. SANITARY SEWER MAIN INSTALLATION

- 1.0 Description. 8” PVC Sanitary Sewer Pipe Replacement shall be constructed at locations and elevations shown on the plans.

- 2.0 Work requirements. Work shall be in accordance with Project Plan and Details for all dimensions, pipe class, materials, and bedding types and sizes. All other aspects of the construction shall comply with City of Rolla Standard Specifications.

- 3.0 Method of Measurement. This work will be measured by the quantity of linear feet placed of sewer pipe measured on top of the ground along the centerline of the trench from point of connection to point of connection.

- 4.0 Basis of Payment. Payment for this work shall include all materials, labor, equipment and time necessary to replace existing sanitary sewer piping with new ductile iron sanitary sewer piping and shall include all connections to existing manholes and existing pipes; demolition of existing piping to be replaced; testing; excavation of all material regardless of character; trenching; bedding; backfill; sawcutting existing pavement and curb; surface restoration to existing pavement elevation if under proposed pavement, to match existing pavement and curb conditions if under existing pavement and curb, or to final grade with seed or sodding as specified if outside pavement areas; and all incidental work required for a complete installation. No separate payment shall be made for rock excavation and removal, shoring, dewatering or any other work incidental to excavation, trenching and backfilling associated with the installation, nor for finish grading, seeding, sodding, pavement or curb restoration, etc necessary for site restoration outside of proposed pavement areas. The accepted quantity will be paid at the contract unit price for Item 13. Sanitary Sewer Pipe Replacement, per linear foot.

N. INLETS

- 1.0 Description. Precast Concrete Inlets shall be constructed at locations and elevations shown on the plans.
- 2.0 Work requirements. Work shall be in accordance with Project Plan and Details for all dimensions, inlet types, materials, grates and curb box types, and bedding. All other aspects of the construction shall comply with City of Rolla Standard Detail Drawings and the Standard Specifications.
- 3.0 Method of Measurement. This work will be measured by each unit assembled, installed and complete in place.
- 4.0 Basis of Payment. Payment for this work shall include all materials, labor, equipment and time necessary to construct the complete unit and shall include precast concrete structure; metal grates and curb boxes; lids; aggregate; excavation of all material regardless of character; bedding; backfill; sawcutting existing pavement and curb; connections to new and existing pipes and structures; restoring the surface to existing pavement elevation for proposed pavement; and all incidental work required for a complete installation. No separate payment shall be made for rock excavation and removal, shoring, dewatering or any other work incidental to excavation and backfilling associated with the installation, nor for finish grading, seeding, sodding, pavement, curb and ground restoration etc necessary to tie into and match existing surfaces to remain in place. The accepted quantity will be paid at the contract unit price for Items 16.-24. For the corresponding inlet type and size, per unit.

O. EROSION CONTROL

- 1.0 Description. Pollution, Erosion and Sediment Control shall be provided as shown on the plan, as directed by the Engineer, or as needed based on site conditions.
- 2.0 Work requirements. Work shall be in accordance with Project Plan and Details and as required depending upon the Contractor's method of operation, seasonal conditions and nature of the work being performed. All other aspects of the construction shall comply with City of Rolla and DNR regulations.
- 3.0 Method of Measurement. This work will not be measured for payment.
- 4.0 Basis of Payment. No direct payment will be made to the contractor to recover the cost of equipment, labor, materials or time required to fulfill the above provisions, unless specified elsewhere in the contract document.

P. ACCESS TO COMMERCIAL AND PRIVATE PROPERTIES

- 1.0 Description. This improvement is in a highly commercial and residential area. While working on entrances or adjacent properties, the contractor shall make every reasonable effort to minimize any interference to the properties and to pursue the work diligently. Under no circumstances shall the contractor block ingress/egress to and from businesses during the normal business hours of each business unless as approved by the property owner and the engineer.
- 1.1 The contractor shall contact each property owner at least 1 week prior to any sidewalk or entrance construction within their property limits to advise them of the work that will take place.

- 2.0 Construction Requirements. On all entrances the contractor shall always keep one-half of the entrance open unless there is not sufficient width that may be left open for vehicle ingress and egress. If there exists more than one entrance to the property, the contractor shall always keep a minimum one entrance to that property completely open unless approved by the property owner and the engineer. If a property has a defined entrance and exit the work on the entrances must be completed during non-business hours including opening of the entrance to traffic.
- 2.1 The contractor has the option of using accelerated portland cement concrete pavement (PCCP) for use in paved approaches and other areas of improvements as shown on the plans or as approved by the engineer. The concrete mixture shall obtain a compressive strength of 3500 pounds per square inch prior to opening to traffic. An accelerator will be allowed as approved by the engineer.

- 4.0 Basis of Payment. No direct payment will be made to the contractor for any expenses incurred for compliance with this provision.

Q. EXISTING UTILITY COORDINATION

- 1.0 Description. Adjacent to these improvements are multiple existing utilities. It is the responsibility of the contractor to coordinate work with the utility companies to make sure when working in the vicinity of existing conduits, piping, duct banks, boxes, services poles, lines, guywires, or any other appurtenances they are left in a state that does not endanger the public and remain in service.
- 2.0 Work requirements. Coordinate work with the utility owners and ensure existing service is maintained.
- 3.0 Method of Measurement. This work will not be measured for payment.
- 4.0 Basis of Payment. No direct payment will be made to the contractor for any expenses incurred for compliance with this provision.

R. PROJECT SIGN

- 1.0 Description. These improvements are partially funded by a grant from the Delta Regional Authority (DRA). A requirement for that funding is the erection and maintenance of a project sign.
- 2.0 Work requirements. Supply, erect, and maintain in good condition a sign conforming to the DRA “Exterior Project Signs” attached to this document. Submit a drawing for approval prior to beginning sign fabrication.
- 3.0 Method of Measurement. This work will not be measured for payment but will be considered a lump sum unit.
- 4.0 Basis of Payment. Payment for this work shall include all materials, labor, equipment and time necessary to fabricate, install and maintain the sign for the duration of the project. The accepted quantity will be paid at the contract lump sum price for Item 33. Project Sign.

S. ASPHALTIC PAVEMENTS

- 1.0 Description. This work shall consist of removal of the existing pavements and placement of base rock and pavement composed of asphaltic concrete constructed on a prepared subgrade. This work shall be performed in accordance with the standard specifications and as shown on the plans or established by the engineer.
- 2.0 This surface course for the roadway shall be known as Plant Mix Bituminous Pavement BP-1 and Bituminous Base and shall be constructed as outlined in City of Rolla Standard 201 for a Collector/Commercial classification. All mix designs must be currently approved by MoDOT for use.
- 3.0 Method of Measurement. The quantities of asphalt mix placed will be verified by delivery tickets clearly showing the quantity of material delivered and installed.
- 4.0 Basis of Payment. The accepted quantity of Base Rock & Asphalt pavements will be paid for by the contract unit bid prices of Items 28.-30.

TECHNICAL SPECIFICATIONS

All work to be completed to City of Rolla Standard details unless noted otherwise.

2300 UNTREATED COMPACTED AGGREGATE

2300.1 SCOPE

This section covers the materials for the construction of the specified base course.

2300.2 MATERIAL

TYPE 5 AGGREGATE (1" MINUS CRUSHED STONE BASE ROCK)

Base rock course material used will be as per MoDOT specifications: Section 1007 – Aggregate for Base.

The gradation in percentages by weight passing square mesh screen shall be as follows:

Type 5 Aggregate shall be in accordance with the following gradation requirements:

Sieve	Percent by Weight (Mass)
Passing 1-inch	100
Passing ½-inch	60-90
Passing No. 4	35-60
Passing No. 30	10-35
Passing No. 200	0-15

CLEAN CRUSHED STONE GRADATIONS:

1" CLEAN AGGREGATE: Clean aggregate furnished shall conform to the grading in the following table:

<u>Sieve Size</u>	<u>% Passing/Retained</u>
1"	100% passing
¾"	95% passing
No. 4	0-5% passing

2" CLEAN AGGREGATE: Clean aggregate furnished shall conform to the grading in the following table:

Sieve Size	% Passing/Retained
2"	95-100% passing
1"	35-70% passing
½"	10-30% passing
No. 4	0-5% passing

2400 CONCRETE CURB AND GUTTER

2400.1 SCOPE

This section governs the furnishing of all labor, equipment, tools, and materials, and the performance of all work necessary to construct curb and gutter completely, as provided for in the Miscellaneous Provisions and by authorized Change Orders.

2400.2 MATERIALS, EQUIPMENT AND DEFINITIONS

A. CONCRETE MIX

The concrete used in the construction of curb and gutter shall be air-entrained with 4 to 6%, minimum 6 bag mix with 2 to 4 inch slump developing 4000 PSI 28 day strength. Aggregate gradation shall conform to ASTM 33 with 1½ inch maximum size aggregate.

CALCIUM CHLORIDE

The use of Calcium Chloride in concrete mixtures will be permitted upon approval by the engineer.

2400.3 CONSTRUCTION DETAILS

The incidental work of clearing, grubbing, demolition, grading, and sub-grade preparation shall be carried well in advance of the construction by the City.

The curb and gutter shall be constructed to the configuration and to the lines and grades shown on the plans. The curb and gutter section shall be placed prior to placement of pavement or sidewalk sections.

GRADING AND SUB-GRADE PREPARATION

The Contractor will be required to backfill to restore final grade by filling with 1” clean crushed stone.

FORMS

All forms shall be in good condition, with not more than one-fourth (¼) inch variation in horizontal and vertical alignment for each ten (10) feet in length. The forms shall be set true to line and grade and shall be adequately supported to stay in position while depositing and consolidating the concrete. They shall be designed and constructed so as to permit their removal without damage to the concrete.

2400.4 JOINTS

The joints shall be formed at right angles to the alignment of the curb and gutter.

EXPANSION JOINTS

Expansion joints shall be formed by a one-half inch thick preformed joint filler, cut to the configuration of the full size of the curb and gutter section, so that they are not moved by depositing and compacting the concrete at these joints. The edges of these joints shall be rounded with an edging tool of one-eighth inch radius. The joints do not require sealer when constructed as shown on the plans and shall be placed every 100 feet.

CONTRACTION JOINTS

Contraction joints shall be removed by a one-quarter inch thick template and cut to the configuration of the curb section. These templates shall be secured so they are not moved by depositing and compacting the concrete. Contraction joints shall be placed every ten feet.

Unless otherwise shown on the plans, and as soon as the concrete has hardened sufficiently, the template shall be removed from all contraction joints. The edges of the joint shall be rounded with an edging tool of one-eighth inch radius.

2400.5 CONCRETE WORK

FINISHING

The curb shall be tooled to the required radius as soon as possible after the concrete takes its initial set. After the forms and templates are removed the joints shall be tooled and curb surface shall be finished with a broom to remove all imperfections without additional mortar and dryer. In all cases the resulting surface shall be smooth and of uniform color with all rough spots, projections and form stakes removed. No plastering of the concrete will be allowed. The finished curb shall have a true surface, free from sags, twists, or warps, and shall have a uniform appearance, and shall be true to the specified lines, grades, and configurations shown on the plans.

CURING

Exposed surfaces of concrete shall be protected from premature drying caused by the hot sun, drying winds, or other causes. Freshly placed concrete shall be protected from damage from rain. The concrete shall be kept continuously wet for a period of not less than five days after pouring. Curing compounds or other methods of curing may be considered by the Public Works Director.

If concrete is placed while the air temperature is less than 40 degrees F. or when freezing is probable within 48 hours, all sand, aggregate, and water shall be heated, and the concrete, when being placed, shall have a temperature of not less than 50 degrees nor more than 100 degrees F. Care must be taken to prevent too

rapid drying of the concrete when it is heated. During freezing weather suitable means shall be provided for maintaining the temperature of the concrete at not less than 50 degrees F. for a period of five days for normal concrete curing.

Before placing concrete during cold weather, forms shall be free from frost, snow and ice. After the concrete is placed, it shall be protected on all exposed sides by tarpaulins or other suitable means. The methods of heating the materials protecting the concrete shall be approved by the Public Works Director. Salts, chemicals or other materials shall not be used in the concrete for the purposes of preventing freezing or for lowering the freezing point of the concrete.

2400.6 MEASUREMENT

Measurement will be made to determine the number of linear feet of each type of Portland cement concrete curb and gutter that are constructed in accordance with the specified Standard Drawings and plans.

2400.7 PAYMENT

The cost of furnishing all labor, equipment, tools and materials, and the performance of all work necessary to completely construct curb and gutter.

2500 CONCRETE DRIVEWAY

2500.1 SCOPE

This section governs the furnishing of all labor, equipment, tools and material, and the performance of all work necessary to completely construct concrete driveway, as provided for in the Miscellaneous Provisions and by authorized Change Orders.

2500.2 MATERIALS, EQUIPMENT AND DEFINITIONS

CONCRETE MIX

The concrete used in the construction of driveways shall be air-entrained with 4 to 6% air, minimum 6-bag mix with 2 to 4 inch slump developing 4000 PSI 28 day strength. Aggregate gradation shall conform to ASTM 33 with 1½-inch maximum size aggregate.

CALCIUM CHLORIDE

The use of Calcium Chloride in concrete mixtures will be permitted upon approval by the engineer.

2500.3 CONSTRUCTION DETAILS

The incidental work of clearing, grubbing, demolition, grading, and sub-grade preparation shall be carried on well in advance of the driveway construction by the City.

The driveway shall be constructed after the curb and gutter has been done and completed.

GRADING AND SUB-GRADE PREPARATIONS

All excavation required in the grading and sub-grade preparation shall be done by the City.

The Contractor will be required to finalize grade by cutting or filling with 1" clean crushed stone supplied by the City.

FORMS

All forms shall be in good condition, with not more than one-fourth inch variation in horizontal and vertical alignment for each ten feet in length. The forms shall be set true line and grade shall be adequately supported to stay in position while depositing and compacting the concrete. They shall be designed and constructed so as to permit their removal without damage to the concrete.

2500.4 EXPANSION JOINTS

Expansion joints constructed on the location shown on the plans, shall be formed one-half inch wide and shall extend the full depth of the slab. All of the joint except for the top one-quarter of an inch below the surface of the driveway slab shall be filled with expansion material.

The Contractor when applying sealer shall follow the manufacturer's instructions for applying the joint sealer. Contractor shall use the equipment that is suitable for the purpose. The compounded sealer material shall be poured into the joint to the level of the adjacent concrete surfaces. Joints must be clean and dry before the sealer is poured.

2500.5 CONCRETE WORK

Joints shall be constructed at the locations shown on the plans. The pre-molded joint filler shall be supported so as to prevent its displacement while depositing concrete at the expansion joints. Pre-molded joint filler shall be positioned to true alignment at right angles on the line of the driveway and be normal to the surface of the concrete.

FINISHING

After the concrete has been thoroughly consolidated and leveled, and the initial set has taken place, the surface shall be finished with a broom with no other mortar than that contained in the concrete. The resulting surface shall be uniform in color with all imperfections removed. The edges shall be rounded with an edging tool having a radius as shown on the plans. Special care shall be taken to insure a straight, neat appearance along the edges of the driveway and at the joints.

CURING

Exposed surfaces of concrete shall be protected from premature drying caused by the hot sun, drying winds, or other causes. Freshly placed concrete shall be protected from damage from rain. The concrete shall be kept continuously wet for a period of not less than five days after pouring. Curing compounds or other methods of curing may be considered by the Public Works Director.

If concrete is placed while the air temperature is less than 40 degrees F. or when freezing is probable within 48 hours, all sand, aggregate, and water shall be heated, and the concrete, when being placed, shall have a temperature of not less than 50 degrees nor more than 100 degrees F. Care must be taken to prevent too rapid drying of the concrete when it is heated. During freezing weather suitable means shall be provided for maintaining the temperature of the concrete at not less than 50 degrees F. for a period of five days for normal concrete curing.

Before placing concrete during cold weather, forms shall be free from frost, snow and ice. After the concrete is placed, it shall be protected on all exposed sides by tarpaulins or other suitable means. The methods of heating the materials protecting the concrete shall be approved by the Public Works Director. Salts, chemicals or other materials shall not be used in the concrete for the purposes of preventing freezing or lowering the freezing point of the concrete.

2500.6 MEASUREMENT

Measurement will be made to determine the number of square feet of Portland cement concrete driveway placed and accepted, for the purpose of making payments.

2500.7 PAYMENTS

2500.7.1 The cost of furnishing all labor, equipment, tools and materials, and the performance of all work necessary to completely construct driveways.

2600 SIDEWALK

2600.1 SCOPE

This section governs the furnishing of all labor, equipment, tools and material, and the performance of all work necessary to completely construct sidewalks, as provided for in the Miscellaneous Provisions and by authorized Change Orders.

2600.2 MATERIALS, EQUIPMENT AND DEFINITIONS

A. CONCRETE MIX

The concrete used in the construction of sidewalks shall be air-entrained with 4 to 6% air, 6 bag mix with 2 to 4 inch slump developing 4000 PSI 28 day strength.

Aggregate gradation shall conform to A.S.T.M. 33 with 1½ inch maximum size aggregate.

A. **CALCIUM CHLORIDE**

The use of Calcium Chloride in concrete mixtures will be permitted upon approval by the engineer.

2600.3 **CONSTRUCTION DETAILS**

The incidental work of clearing grubbing, demolition, grading, and sub-grade preparation shall be carried on well in advance of the sidewalk construction as herein specified.

The sidewalks shall be constructed after the curb and gutter has been done and completed.

A. **GRADING AND SUB-GRADE PREPARATIONS**

All excavation required in the grading and sub-grade preparation shall be done by the City.

The Contractor will be required to finalize grade by cutting or filling with 1” clean crushed stone supplied by the City.

B. **FORMS**

All forms shall be in good conditions, with not more than one-fourth (¼) inch variation in horizontal and vertical alignment for each ten (10) feet in length. The forms shall be set true to line and grade shall be adequately supported to stay in position while depositing and compacting the concrete. They shall be designed and constructed so as to permit their removal without damage to the concrete.

2600.4 **EXPANSION JOINTS**

Expansion joints constructed on the locations shown on the plans, shall be formed one-half (½) inch wide and shall extend the full depth of the slab. All of the joints except for the top one-quarter (¼) of an inch below the surface of the sidewalk slab shall be filled with expansion material. Expansion joints shall be placed every thirty (50) feet.

The Contractor when applying sealer shall follow the manufacturer instructions for applying the joint sealer. He shall use the equipment that is suitable for the purpose. The compound sealer material shall be poured into the joint to the level of the adjacent concrete surfaces. Joints must be clean and dry before the sealer is poured.

2600.5 **CONTRACTION JOINTS**

The sidewalk surface shall be marked off into rectangular sections by contraction joints as shown on the plans. The joints shall be one-eighth (1/8) inch wide by one (1) inch deep, and may be formed either by inserting a fiber strip, tooling, or by use of a concrete saw. Contraction joints shall be cut every five (5) feet.

2600.6 **CONCRETE WORK**

Joints shall be constructed at the locations shown on the plans. The pre-molded joints as shown on the plans. The pre-molded joint filler shall be supported so as to prevent its displacement while depositing concrete at the expansion joints. Pre-molded joint filler shall be positioned in true alignment at right angles to the line of the sidewalk and be normal to the surface of the concrete.

A. **FINISHING**

After the concrete has been thoroughly consolidated and leveled, and the initial set has taken place, the surface shall be finished with a soft wood or cork float and either burlap or broom finished with no other mortar than that contained in the concrete. The resulting surface shall be uniform in color with all imperfections removed. The edges shall be rounded with an edging tool having a radius as shown on the plans. Special care shall be taken to insure a straight, neat appearance along the edges of the sidewalk and at the joints.

D. **CURING**

Exposed surfaces of concrete shall be protected from premature drying caused by the hot sun, drying winds, or other causes. Freshly placed concrete shall be protected from damage from rain. The concrete shall be kept continuously wet for a period of not less than five days after pouring. Curing compounds or other methods of curing may be considered by the Public Works Director.

If concrete is placed while the air temperature is less than 40 degrees F. or when freezing is probable within 48 hours, all sand, aggregate, and water shall be heated, and the concrete, when being placed, shall have a temperature of not less than 50 degrees nor more than 100 degrees F. Care must be taken to prevent too rapid drying of the concrete when it is heated. During freezing weather suitable means shall be provided for maintaining the temperature of the concrete at not less than 50 degrees F. for a period of five days for normal concrete curing.

Before placing concrete during cold weather, forms shall be free from frost, snow and ice. After the concrete is placed, it shall be protected on all exposed sides by tarpaulins or other suitable means. The methods of heating the materials protecting the concrete shall be approved by the Public Works Director. Salts, chemicals, or

other materials shall not be used in the concrete for the purposes of preventing freezing or for lowering the freezing point of the concrete.

2600.7 **MEASUREMENT**

Measurement will be made to determine the number of square feet of Portland cement concrete sidewalk placed and accepted, for the purpose of making payments.

2600.8 **PAYMENT**

The cost of furnishing all labor, equipment, tools and materials, and the performance of all work necessary to construct sidewalk, complete, including all incidental work necessary in grading and sub-grade preparation at the locations specified herein, shall be included in the unit bid price per square foot, listed in the proposal as "Concrete Sidewalk".

Cores taken from Rolla Street all represent total thickness of approximately 13 inches of pavement

5th-6th St.

6th-7th St.

7th-8th St.

8th-9th St.

9th-10th St.

10th-11th St.





Delta
Regional
Authority

Exterior Project Signs

The project contractor shall supply, erect, and maintain in good condition a project sign according to the specifications and guidelines set forth in this document.

If the project involves construction that is visible to the public, signage should be included in a conspicuous area.

The grantee shall be responsible for all costs associated with the production and installation of all project signage.

The DRA seal should be included in equivalent size to the identities of other agencies on signage for projects also funded by USDA, EDA, and other funding partners.

Project signs shall not be erected on public street/highway rights-of-way. If any possibility exists for obstruction of traffic line of sight, the location and height of the sign should be coordinated with the agency responsible for street or highway safety in the area.

Delta Regional Authority may permit modification of these specifications if they conflict with state law or local ordinances.

Material Specifications

Panel: 4' x 8' x 3/4" exterior grade MDO plywood (APA rating A-B).

Posts: 4" x 4" x 12' structural grade treated Douglas Fir or Southern Yellow Pine, No.1 or better. 2" X 4" bracing of equivalent material shall be installed per the attached drawing. If local winds require, additional braces shall be added to ensure the sign does not blow over.

Finish Schedule

Panel: Plywood shall be primed and painted overall SW

7006 Extra White (or equivalent) exterior enamel.

A 12" high band of SW 6510 Loyal Blue (or equivalent) shall be painted across the bottom of the panel to include the left, right and bottom edges.

Posts: Posts shall be primed and painted SW 6510 Loyal Blue (or equivalent).

Formatting Instructions

Instructions for laying out the graphics for a typical project sign are provided on the last page of this document.

Vector Digital Artwork

In an effort to ensure consistency and make the job easier, DRA provides digital vector artwork. These vector files are in .ai format with all type converted to outlines. Sizing instructions for each sign component appear on the layout sheet (page 4).

For DRA digital artwork, please contact **Ryan Sayles** at rsayles@dra.gov.



Delta
Regional
Authority

Exterior Project Signs

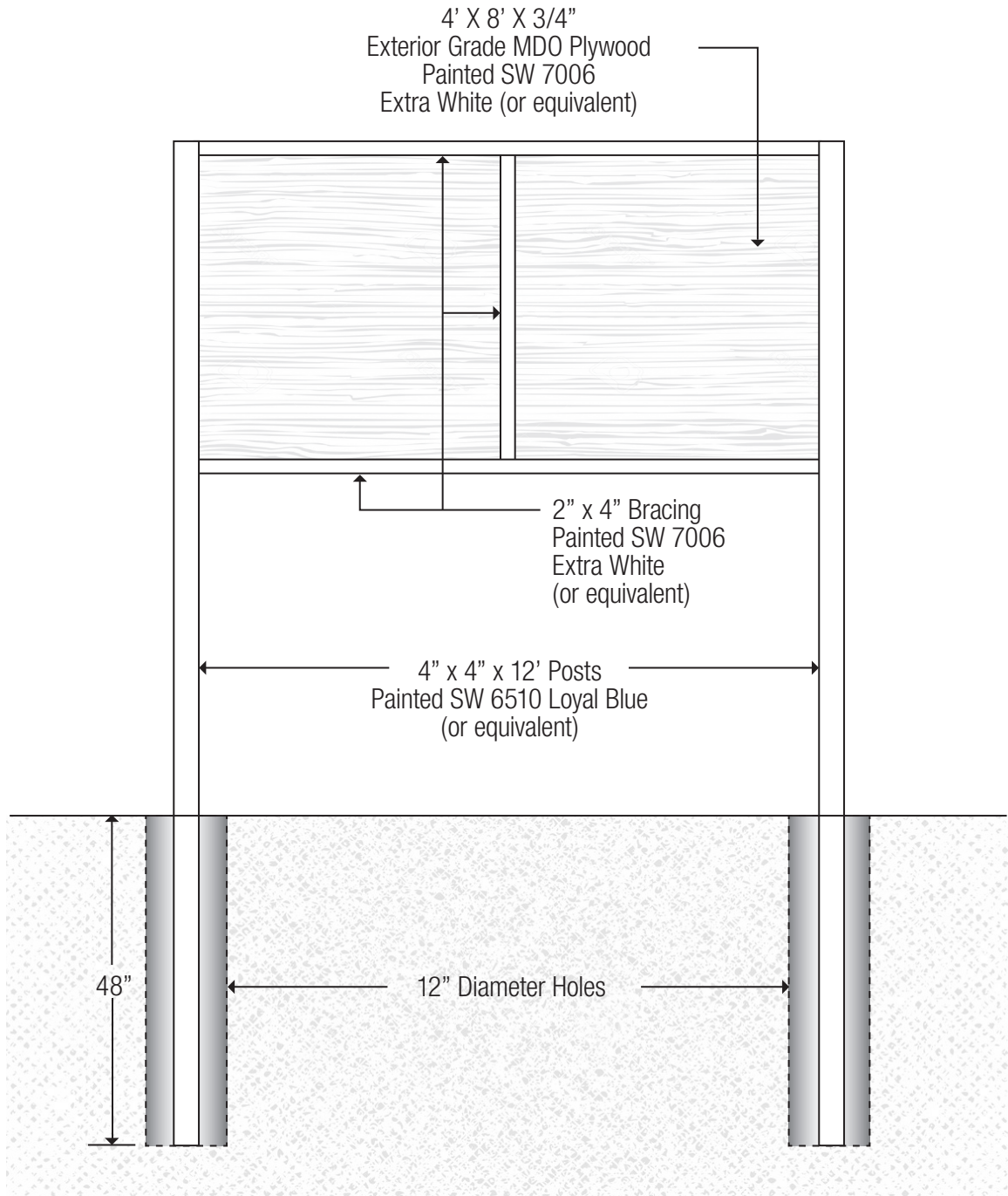

Framing and Installation Details

(Rear View of Sign)



Delta
Regional
Authority

Graphic Elements

The Delta Regional Authority Identity consists of several key elements. Examples are shown below. For DRA digital artwork, please contact Ryan Sayles at rsayles@dra.gov.

DRA Seal with Logotype (color)



Delta Regional Authority

NOTE: *The DRA Seal is used without the logotype on project signs where DRA is the primary funding source (see example on page 4)*

DRA Funding Line, States Listing and Social Media Icons

Visit us at dra.gov



Funded by Delta Regional Authority

ALABAMA • ARKANSAS • ILLINOIS • KENTUCKY • LOUISIANA • MISSISSIPPI • MISSOURI • TENNESSEE

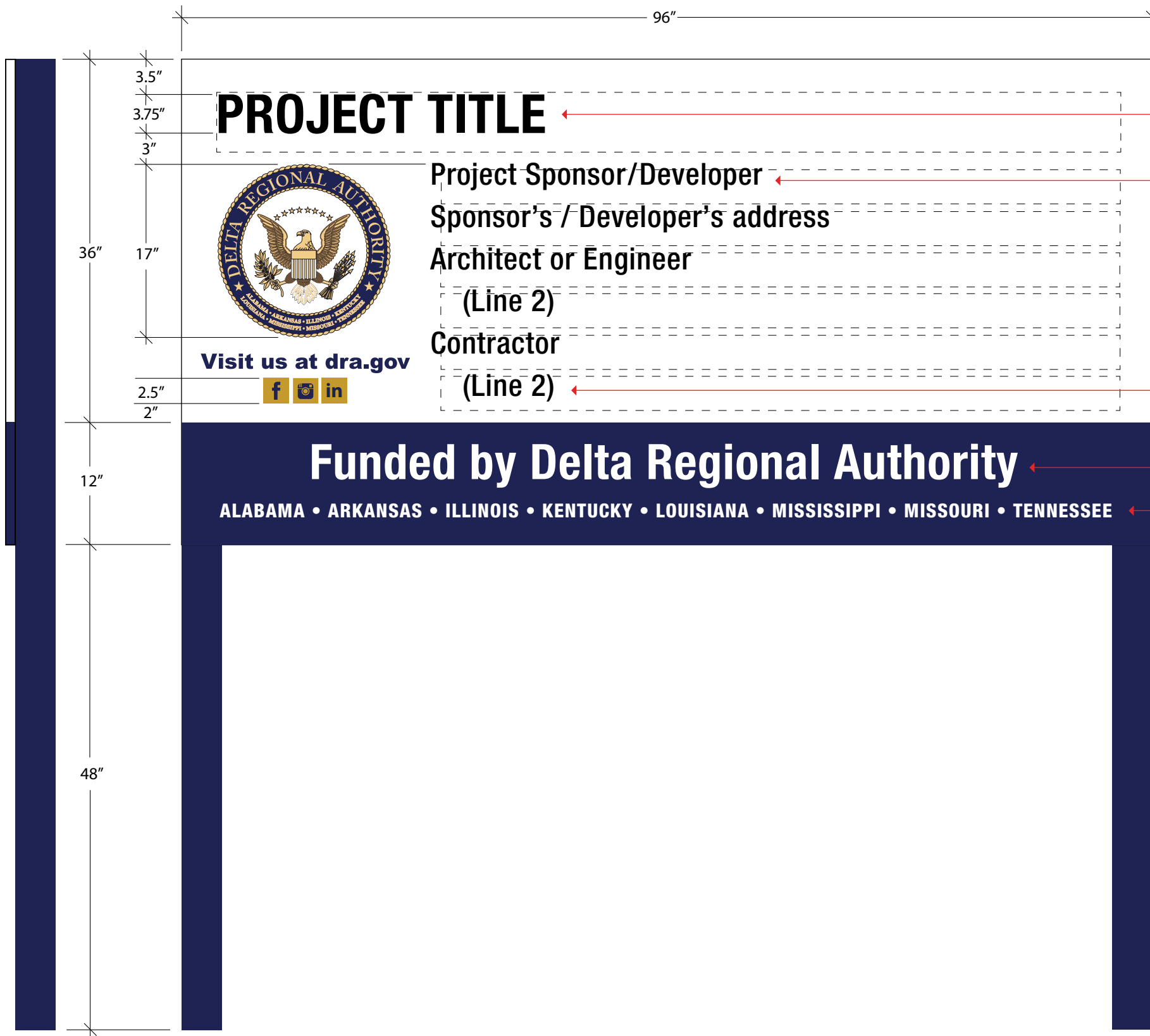

Project title lettering X-height shall be 3.75". The font is Helvetica Neue 77, Bold Condensed, cut from black 3M Scotchcal vinyl or equivalent.

Sponsor, Architect and Engineer lettering X-height shall be 2". The font is Helvetica Neue 77, Medium Condensed, cut from black 3M Scotchcal vinyl or equivalent. (minimum lettering X-height shall be 1.75")

"Funded by" type X-height is 3.5" (a vector file for both lines of type is available. See contact below)
 "State list" type X-height is 1.4"

All lettering shall be cut from white 3M Scotchcal vinyl, or equivalent. An alternate method is to direct print all artwork, including the blue band, from a digital file directly to the painted substrate.

For DRA digital artwork, please contact Ryan Sayles at rsayles@dra.gov.

General Notes

Size: 4' x 8' x 3/4"

Material: Exterior grade MDO plywood (APA rating A-B)

Posts: 4" x 4" x 12' posts
 Posts shall be set in a 12" diameter hole a minimum of four feet deep. If local winds require, braces should be added to ensure the sign does not blow over.

DRA Seal: 17" diameter shall be printed on white 3M Scotchcal, or equivalent vinyl, with solvent-based inks.

For DRA digital artwork, please contact Ryan Sayles at rsayles@dra.gov.

No.	Revision / Issue	Date

 **Delta Regional Authority**
 236 Sharkey Avenue
 Suite 400 / Clarksdale, MS 38614
 Phone: (662) 624-8600
<https://dra.gov>

Project Name:
Construction Project Signs

Project:	Sheet: 1/2
Date: July 2019	
Scale: 1" = 1'	



The Delta Regional Authority Seal and Logotype must appear on project signs where DRA is a partial funding source.

While the overall size may vary, the Seal and Logotype shall have equivalent optical weight (simply put, one ID should not visually dominate another) as the identities of other federal, state or local funding sources.

NOTE: The spatial relationship between the DRA Seal and Logotype is fixed and should never be altered. Likewise, the font used in the logotype should never be altered.

For DRA digital artwork, please contact Ryan Sayles at rsayles@dra.gov.

General Notes

Size: 4' x 8' x 3/4" (typical)

DRA Seal: Shall be printed on white 3M Scotchcal, or equivalent vinyl, with solvent-based inks. The seal may be die cut using the vector circular outline built into the artwork.

DRA Logotype: The logotype may be printed on a finished substrate, along with the Seal, but it may also be cut from black 3M Scotchcal, or equivalent vinyl, and applied directly to the substrate.

For DRA digital artwork, please contact Ryan Sayles at rsayles@dra.gov.

No.	Revision / Issue	Date

 **Delta Regional Authority**
 236 Sharkey Avenue
 Suite 400 / Clarksdale, MS 38614
 Phone: (662) 624-8600
<https://dra.gov>

Project Name:
Partial Funding Project Signs

Project:	Sheet:
Date: July 2019	2/2
Scale: 1" = 1'	